

# PUD Plan Urbanistic de Detaliu

## REGLEMENTARI URBANISTICE

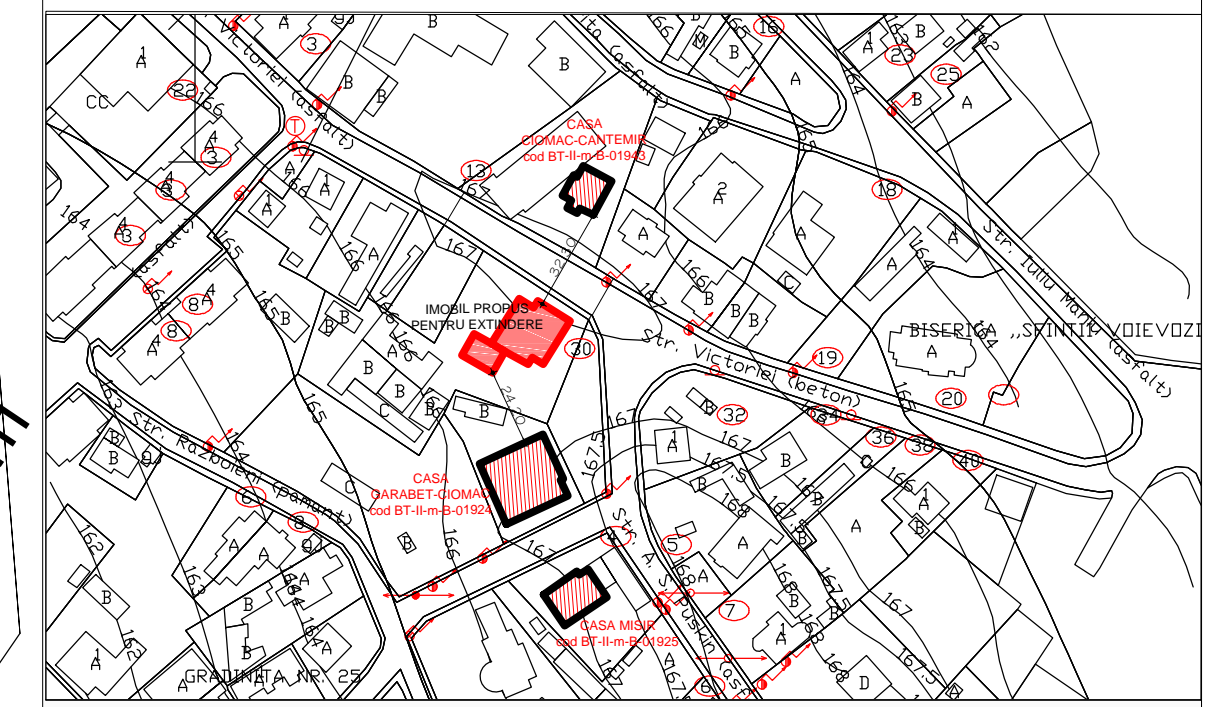

### OBIECTIVE PROPUSE :

**CONSTRUIRE EXTINDERE SEDIU BIROURI PE TERASA EXISTENTA**

str. Victoriei, nr. 30, mun. Botosani

Teren proprietate privata = 2841.00 mp intravilan

Beneficiar : SC. ART-NOUVEAU SRL.

### LIMITE:

LIMITA PROPRIETATE

### REGLEMENTARI URBANISTICE:

- CONSTRUCTIE EXISTENTA PROPRIETATE SC ART-NOUVEAU-IMPEX SRL
- EXTINDERE PROPUASA
- CONSTRUCTII EXISTENTE PE LOTURI VECINE
- CONSTRUCTII EXISTENTE-MONUMENT
- ACCES PRINCIPAL CONSTRUCTII
- ACCES SECUNDAR CONSTRUCTII
- ACCES CAROSABIL IN INTERIORUL PARCELEI
- ALEI PIETONALE IN INTERIORUL PARCELEI
- SPATIU VERDE AMENAJAT
- CIRCULATII CAROSABILE
- CIRCULATII PIETONALE

### BILANT TERITORIAL EXISTENT-PROPUSE

sediu SC ART-NOUVEAU SRL. S.teren = 2841.00 mp	existent mp	propus mp
constructii existente	761.73	837.28
constructii propuse	75.55	
terasa neacoperita	75.55	
circulatii alei pietonale	209.87	209.87
circulatii auto	373.45	373.45
spatii verzi	1420.40	1420.40
POT	26.74%	30.00%
CUT	0.26	0.30

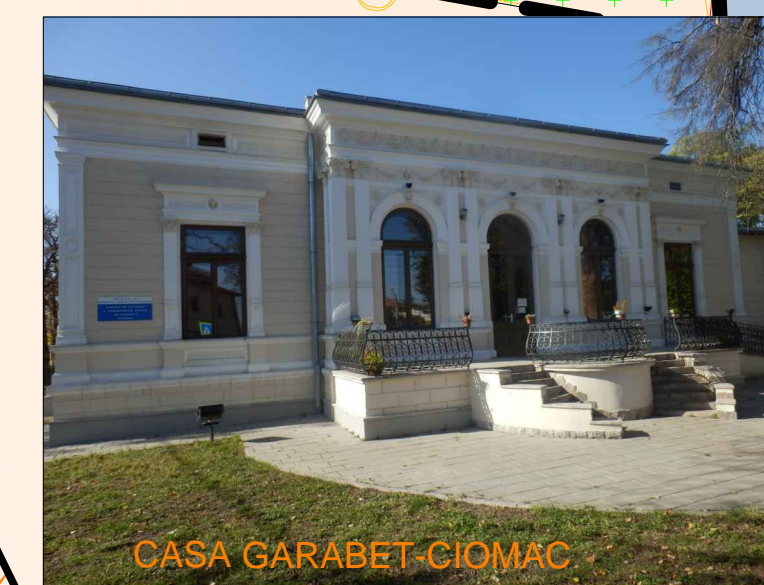
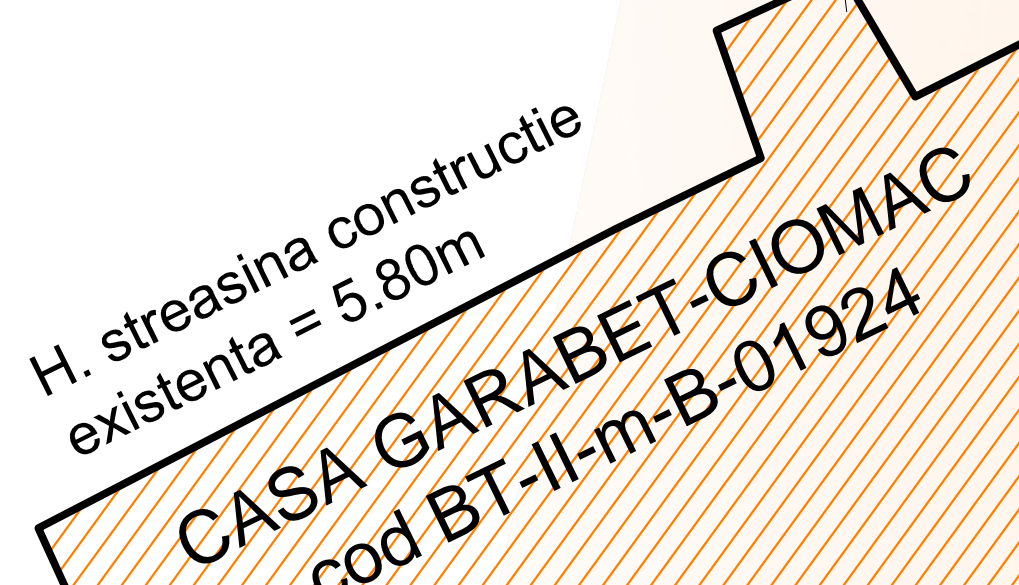
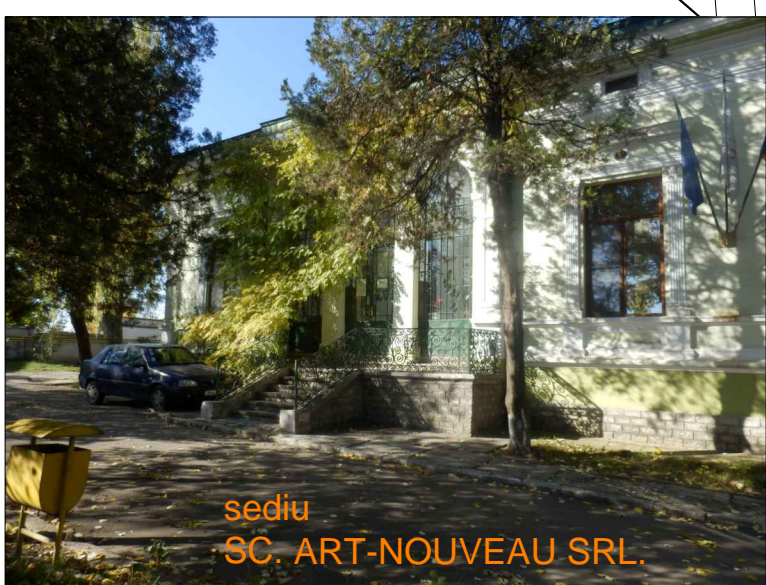
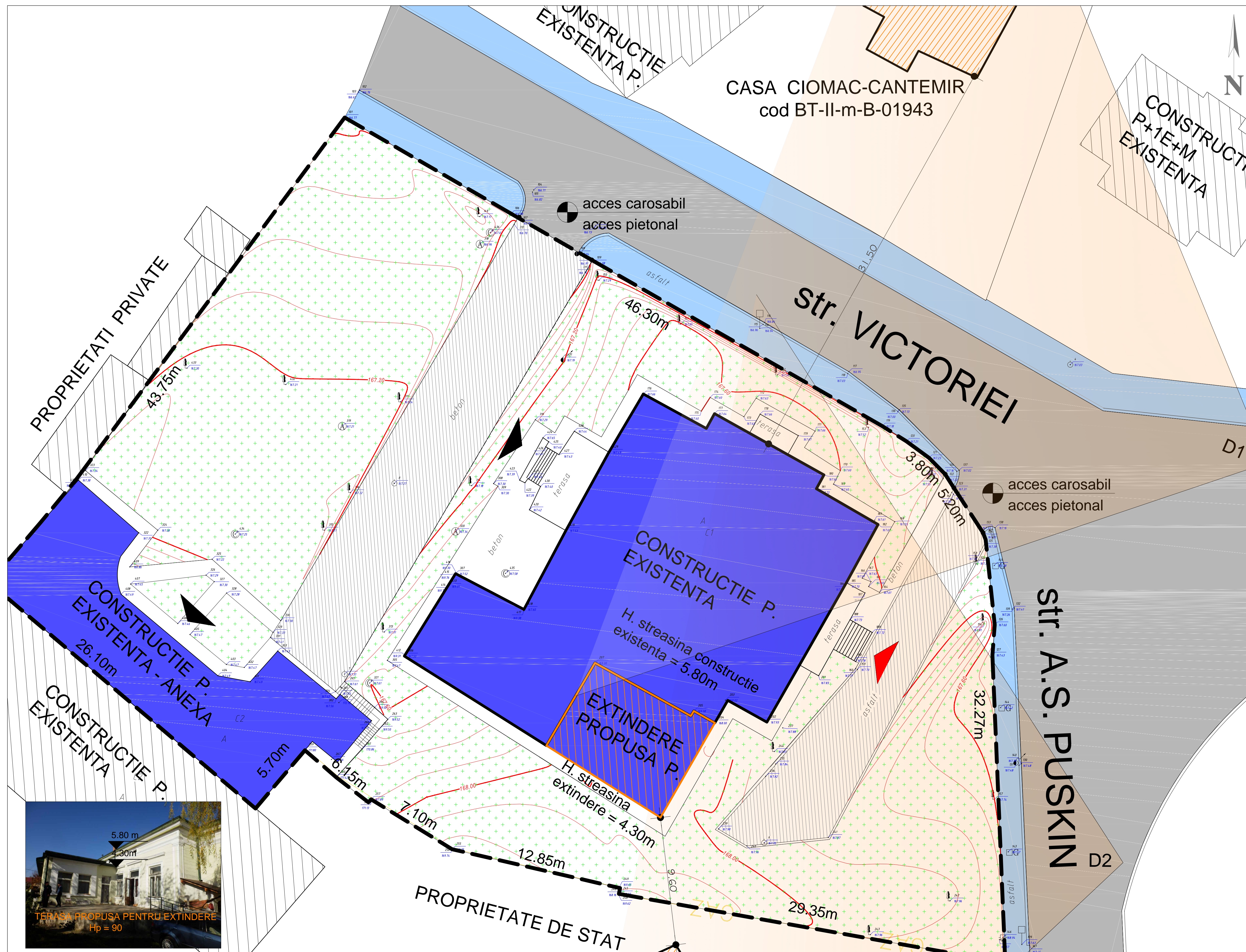

VERIFICATOR/ EXPERT	NUME	SEMNAURA	CERINTA	
PROIECTANT GENERAL SC "PROIECT BOTOSANI" SRL str. Teatrului nr.3A BOTOSANI TEL/FAX:0231-514965; C.F. : 4906270; R.C. J07/1086/1993				BENEFICIAR: SC. ART-NOUVEAU IMPEX SRL. PR.NR. 1963/2015
SPECIFICATIE	NUME	SEMNAURA	SCARA : 1:500	PROIECT: CONSTRUIRE EXTINDERE SEDIU BIROURI PE TERASA EXISTENTA FAZA : P.U.D.
SEF PROIECT	ARH.M. TULBURE			STR. VICTORIEI, NR. 30, MUN. BOTOSANI
PROIECTAT			DATA : 12/2015	REGLEMENTARI URBANISTICE
DESENAT	ARH.R. PRISACARIU			PLANSA NR. A3