

P.U.D. | EXTINDERE APARTAMENT

1419/2014

STRADA VILCELE NR. 15. - BOTOSANI



coordonator urbanism: arh. D.O. BOTEZ

**S.C. "CASA CHIRIAC" S.R.L.
BOTOSANI**
R.C.J. J07 / 372 / 1992 - TEL. 0744.700798

beneficiar: **BRINZARIU CONSTANTIN**
proiect: " **Recompartimentare si extindere apartament "**
Strada Vilcele nr.15 bl.X5 ap.2

1419/2014
faza:
P.U.D.

sef proiect: c.arh.marcel d.chiriac
proiectat: c.arh.marcel d.chiriac
procesat: urb. loredana chiriac

scara: **INCADRARE IN ZONA**
1/2000
nov.2014



LEGENDA

- ✕ **LIMITA ZONA STUDIATA = 573.88 mp.**

- CONSTRUCTII EXISTENTE = 67.24 mp.**
SPATII PRIPRIETATE BRINZARIU CONSTANTIN
- CONSTRUCTII EXISTENTE = 99.72 mp.**
SPATII PRIPRIETATE SI SPATII COMUNE
- ALEI TROTUARE = 105.37mp.**
- ALEI CAROSABILE = 109.07 mp.**
- SPATII VERZI AMENAJATE = 192.58 mp.**

- accese existente**

P.O.T. = 29.09%

C.U.T. = 1.455

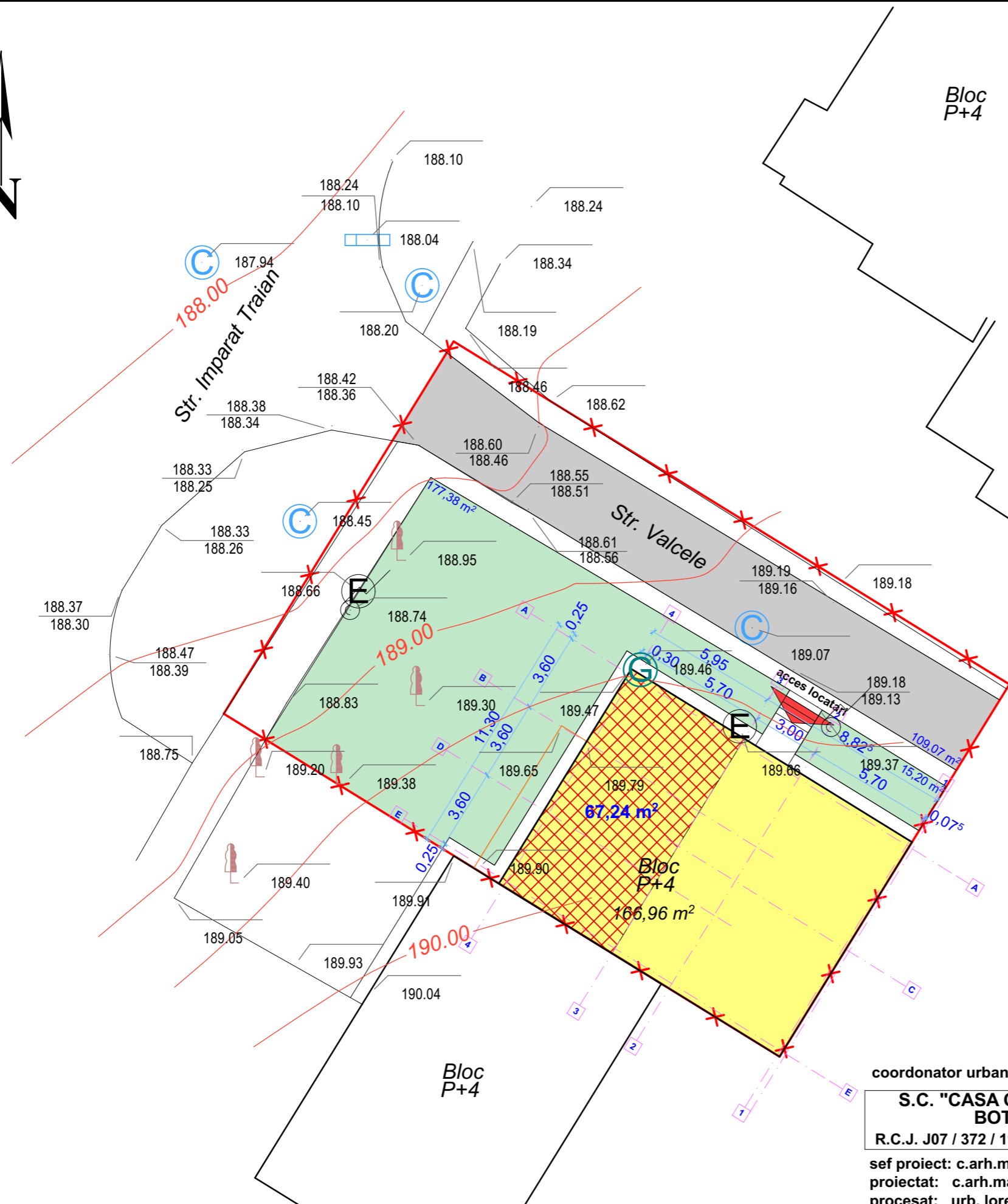

coordonator urbanism: arh. D.O. BOTEZ

**S.C. "CASA CHIRIAC" S.R.L.
BOTOSANI**
R.C.J. J07 / 372 / 1992 - TEL. 0744.700798

beneficiar: **BRINZARIU CONSTANTIN**
proiect: "Recompartimentare si extindere apartament "
Strada Vilcele nr.15 bl.X5 ap.2

1419/2014
faza:
P.U.D.

sef proiect: c.arh.marcel d.chiriac
proiectat: c.arh.marcel d.chiriac
procesat: urb. loredana chiriac

scara:
1/200
nov.2014

SITUATIA EXISTENTA



LEGENDA

- X **LIMITA ZONA STUDIATA = 573.88 mp.**

- CONSTRUCTII EXISTENTE = 67.24 mp.**
SPATII PRIPRIETATE BRINZARIU CONSTANTIN
- CONSTRUCTII EXISTENTE = 99.72 mp.**
SPATII PRIPRIETATE SI SPATII COMUNE
- EXTINDERE LOCUINTA = 18.50 mp.**
REALIZATA PE TEREN CONCESIONAT
- ALEI TROTUARE = 105.26mp.**
- ALEI CAROSABILE = 109.07 mp.**
- SPATII VERZI AMENAJATE = 174.09 mp.**

- accese existente**

P.O.T. = 32.31%

C.U.T. = 1.487

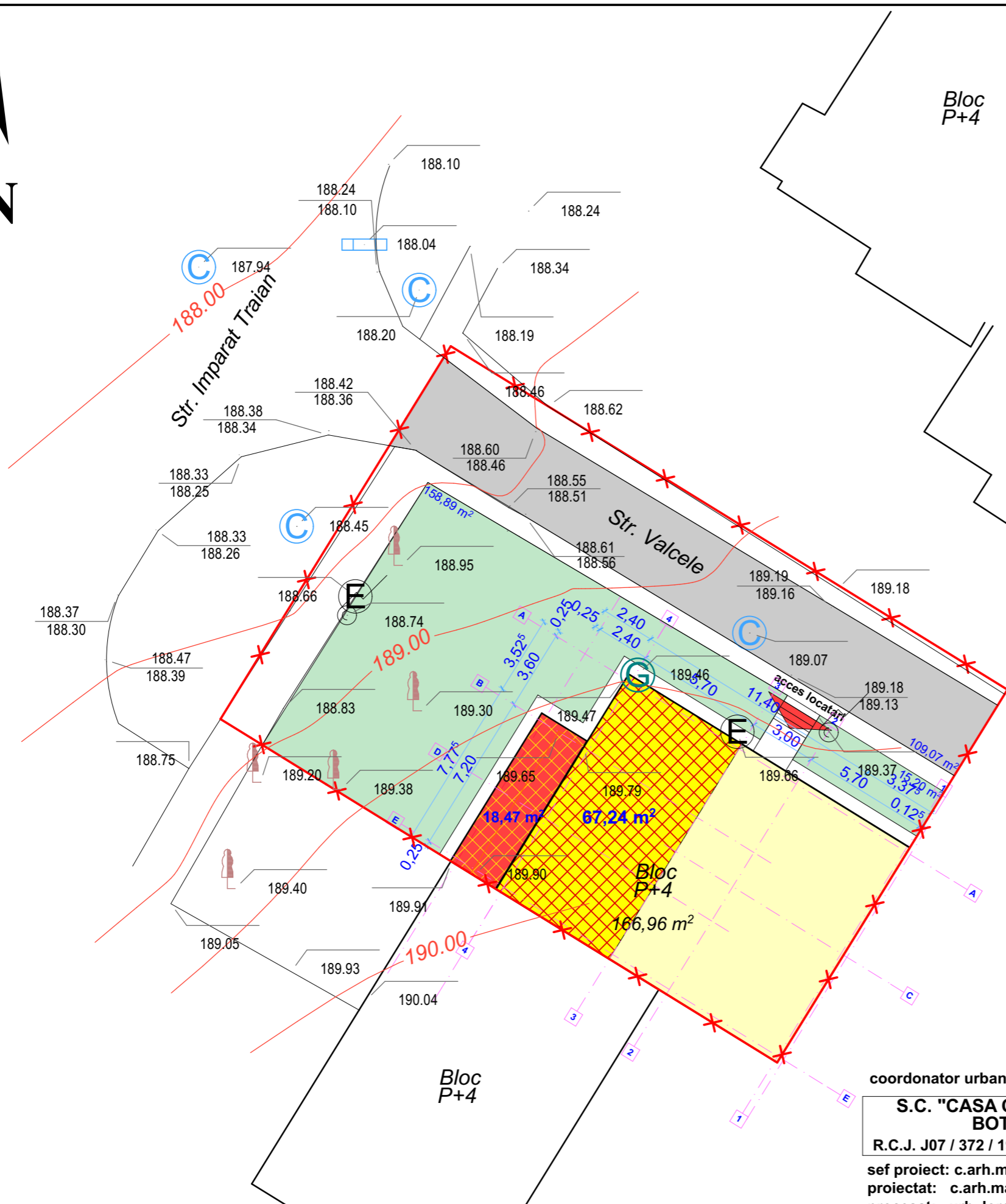

BILANT TERITORIAL

S. ZONA STUDIATA	EXISTENT		PROPOS	
	mp	%	mp	%
S. ZONA STUDIATA	573.88	100.00 %	573.88	100.00 %
S. CONSTRUCTII EXISTENTE	166.96	29.09 %	166.96	29.09 %
S. EXTINDERI PROPUSE	0.00	0.00 %	18.50	3.28 %
S. ALEI CAROSABILE	109.07	19.00 %	109.07	19.00 %
S. ALEI SI TROTUARE	105.37	18.36 %	105.26	18.30 %
S. SPATII VERZI	192.58	33.55 %	174.09	30.33 %

coordonator urbanism: arh. D.O. BOTEZ

**S.C. "CASA CHIRIAC" S.R.L.
BOTOSANI**
R.C.J. J07 / 372 / 1992 - TEL. 0744.700798

beneficiar: **BRINZARIU CONSTANTIN**
proiect: "Recompartimentare si extindere apartament "
Strada Vilcele nr.15 bl.X5 ap.2

1419/2014
faza:
P.U.D.

sef proiect: c.arh.marcel d.chiriac
proiectat: c.arh.marcel d.chiriac
procesat: urb. loredana chiriac

scara:
1/500
nov.2014

REGLEMENTARI URBANISTICE



LEGENDA



LIMITA ZONA STUDIATA = 573.88 mp.

TEREN COTA INDIVIZA = 166.96 mp.

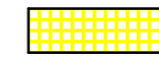

T.CONSTRUCTII EXISTENTE
AFERENT SPATII PRIPIETATE LOCATARI

TEREN CONCESIUNE = 18.50 mp.



T.CONSTRUCTII EXTINDERE
PROPRIETATE PRIMARIE - AFERENT EXTINDERE LOCUINTA

ALTE TERENURI = 388.42 mp

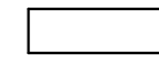

T.ALEI TROTUARE - SPATII VERZI
PROPRIETATE PRIMARIE - AFERENT ALEI TROTUARE SPATII VERZI

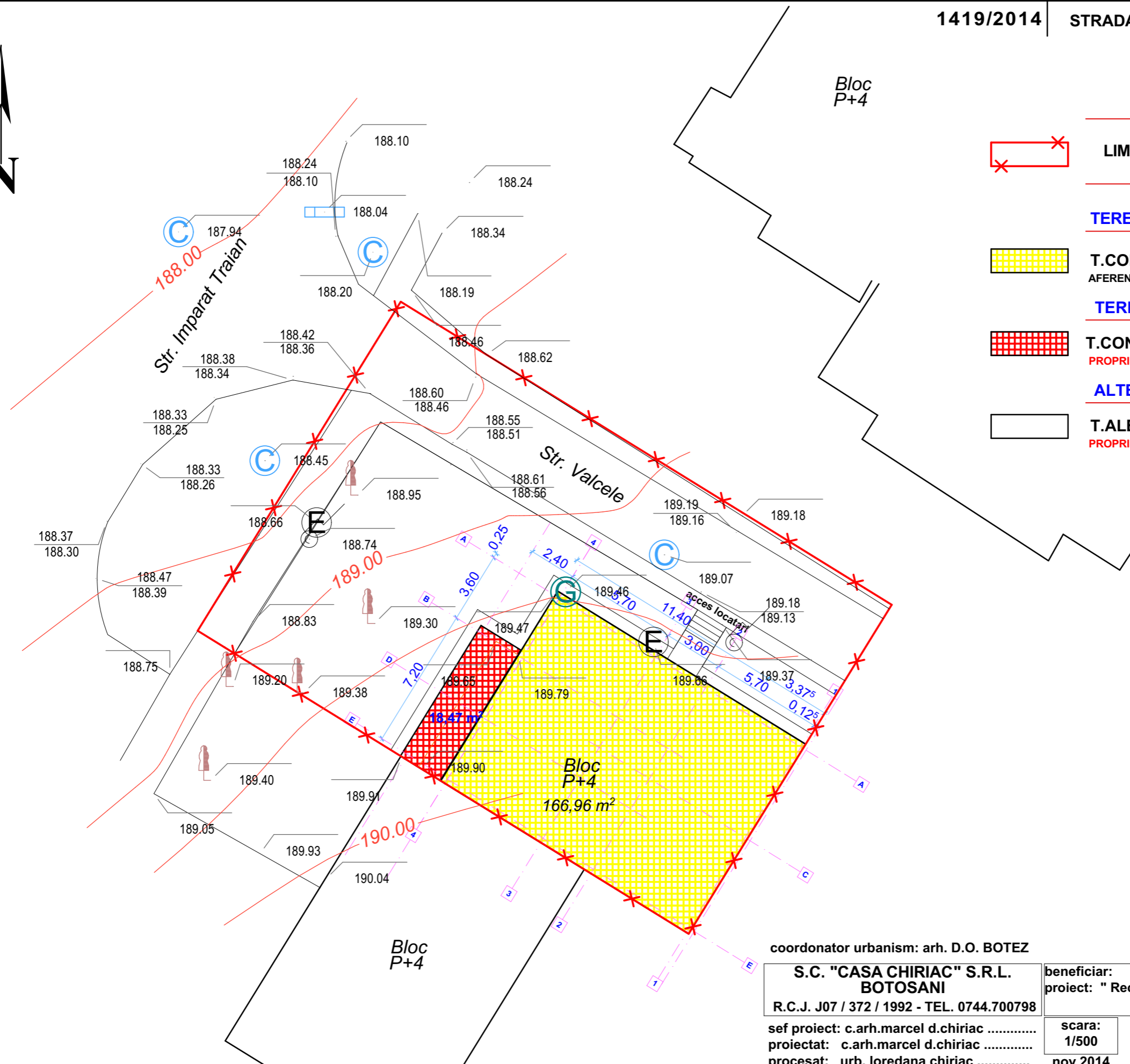

coordonator urbanism: arh. D.O. BOTEZ

**S.C. "CASA CHIRIAC" S.R.L.
BOTOSANI**
R.C.J. J07 / 372 / 1992 - TEL. 0744.700798

beneficiar: BRINZARIU CONSTANTIN
proiect: "Recompartimentare si extindere apartament "
Strada Vilcele nr.15 bl.X5 ap.2

1419/2014
faza:
P.U.D.

sef proiect: c.arh.marcel d.chiriac
proiectat: c.arh.marcel d.chiriac
procesat: urb. loredana chiriac

scara:
1/500
nov.2014

MISCAREA TERENURILOR

P.U.D. | EXTINDERE APARTAMENT

1419/2014

STRADA VILCELE NR. 15. - BOTOSANI



coordonator urbanism: arh. D.O. BOTEZ

S.C. "CASA CHIRIAC" S.R.L. BOTOSANI R.C.J. J07 / 372 / 1992 - TEL. 0744.700798	beneficiar: BRINZARIU CONSTANTIN proiect: " Recompartmentare si extindere apartament " Strada Vilcele nr.15 bl.X5 ap.2	1419/2014 faza: P.U.D.
sef proiect: c.arh.marcel d.chiriac	scara: PREZENTARE - PERSPECTIVA P1.	
proiectat: c.arh.marcel d.chiriac	
procesat: urb. loredana chiriac	nov.2014	

P.U.D. | EXTINDERE APARTAMENT

1419/2014

STRADA VILCELE NR. 15. - BOTOSANI



coordonator urbanism: arh. D.O. BOTEZ

S.C. "CASA CHIRIAC" S.R.L. BOTOSANI R.C.J. J07 / 372 / 1992 - TEL. 0744.700798	beneficiar: BRINZARIU CONSTANTIN proiect: " Recompartmentare si extindere apartament " Strada Vilcele nr.15 bl.X5 ap.2	1419/2014 faza: P.U.D.
sef proiect: c.arh.marcel d.chiriac	scara: PREZENTARE - AXONOMETRIA A1.	
proiectat: c.arh.marcel d.chiriac	
procesat: urb. loredana chiriac	nov.2014	