

695900

695900







695880

695880

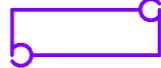
695860

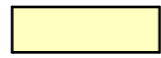

LEGENDA

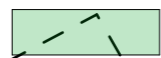
-  **LIMITA ZONA STUDIATA**
-  **LIMITA DE PROPRIETATE = 591,00 mp.**
PROPRIETATE PRIVATA DANILA VASILICA
-  **CONSTRUCTII PROPUSE = 115,33 mp.**
LOCUINTA P+M - A.C.P. 86,08 mp; - A.C.M. 86,08 mp.
ANEXE S+P - A.C.S. 29,25 mp; - A.C.P. 29,25 mp.
-  **IMPREJMUIRE TEREN - PARTIALA** 18,75 ml.
-  **ALEI TROTUARE** = 113,48 mp.
-  **CAROSABIL PARCARI** = 74,14 mp.
-  **SPATII VERZI** = 348,18 mp.

accese propuse

Locuinta H cornisa = 4,50 m Anexe H cornisa = 2,50 m
Locuinta H coama = 7,80 m Anexe H coama = 3,90 m

Coefficienti calculati conform R.L.U. 7.3.2b.24
A.C. = 86,08 mp A.D.C. = 172,16 mp

P.O.T. = 14,56%

C.U.T. = 0,291

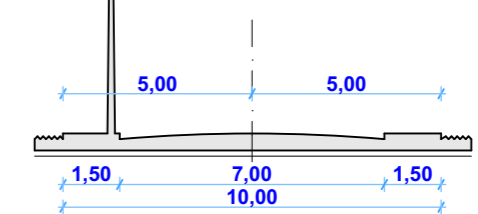

PROFIL STRADAL PROPUSE

BILANT TERITORIAL

| S. PARCELA | EXISTENT | | PROPUS | |
|----------------------|----------|---------|--------|---------|
| | 591.00 | 100.00% | 591.00 | 100.00% |
| S. C. LOCUINTA | 0.00 | 0.00% | 86.08 | 14.56% |
| S. C. ANEXE | 0.00 | 0.00% | 29.15 | 4.95% |
| S. CAROSABIL PARCARI | 0.00 | 0.00% | 74.14 | 12.54% |
| S. ALEI TROTUARE | 0.00 | 0.00% | 113.48 | 19.20% |
| S. SPATII VERZI | 591.00 | 100.00% | 348.18 | 48.75% |

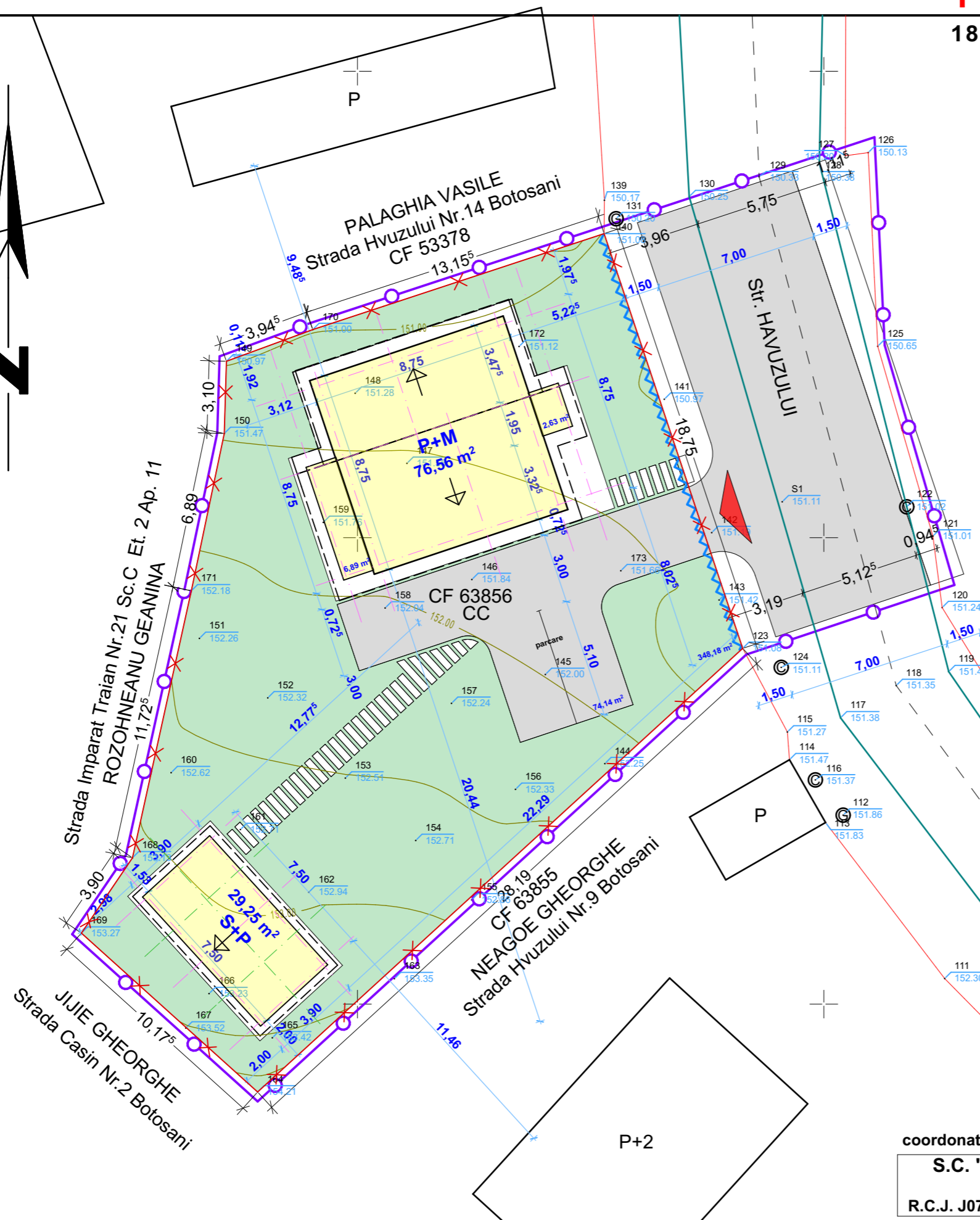

coordonator urbanism arh.D.O.BOTEZ

S.C. "CASA CHIRIAC" S.R.L.
BOTOSANI
R.C.J. J07 / 372 / 1992 - TEL. 0744.700798

sef proiect: c.arh.marcel d.chiriac
proiectat: c.arh.marcel d.chiriac
procesat: c.arh.marcel d.chiriac

beneficiar: **DANILA VASILICA**
proiect: **CONSTRUIRE LOCUINTA, ANEXE si IMPREJMUIRE**
Strada Havuzului Nr. 11 - Botosani

scara: **1/200**
aug.2018

1817/2018
faza:
P.U.D.