

- LEGENDA**
- ● ● ● limita zonei studiate
 - limita de proprietate Haidau-Elena Camelia
 - limita de proprietate pers. fizice sau juridice
 - ▭ cladiri existente
 - ▨ spatii verzi
 - ▧ alei pietonale
 - ▩ alei carosabile
- structura**
- ▨ durabila- caramida, piatra , beton
 - ▩ semidurabile
- starea cladirilor**
- ▨ buna
 - ▩ mediocra

BILANT TERITORIAL	existent	procent
suprafata teren	500,0	100%
spatii verzi	500,0	100%
alei, platforme, circulatii pietonale	0.00	
circulatii carosabile	0.00	
suprafata desfasurata construita la sol Sc	0.00	
suprafata desfasurata construita totala SD	0.00	
P.O.T.	0.00%	
C.U.T.	0.00	
regim de inaltime	-	

PROIECTANT GENERAL				BENEFICIAR: PRIMARIA MUN. BOTOSANI		Pr.Nr. 1892/ 2015
 SOCIETATEA COMERCIALA PROIECT BOTOSANI S.R.L.				SC "PROIECT BOTOSANI" SRL BOTOSANI, Str. Cuza Voda Nr. 2, Bl.7, Sc. F, Mezanin tel/fax: 0231-514965; cf : 4906270; r.c. j07/1086/1993		
SPECIFICATIE		NUME		SEMNATURA		Scara 1:200
SEF PROIECT		arh.M.TULBURE				
COORDONATOR		arh.M.TULBURE				
PROIECTAT		arh. C. HARALAMB				
DESENAT		arh. C. HARALAMB				DATA 03/2015
PROIECT: CONSTRUIRE LOCUINTA P+M STR. BUCOVINA NR.54 MUN. BOTOSANI						
TITLU PLANSA: SITUATIA EXISTENTA						FAZA : P.U.D.
PLANSA NR. A2						

P.U.D.

CONSTRUIRE LOCUINTA P+M

P	regim de inaltime
2,95	H maxim la cornisa
5,90	H. maxim la coama
	tip acoperis- sarpanta

	acces auto la parcela
	acces pietonal la parcela
	acces principal la constructii
	accese secundare la constructii

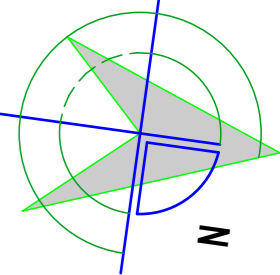

LEGENDA

- limita zonei studiate
- limita de proprietate Haidau Elena-Camelia
- limita de proprietate pers. fizice sau juridice
- cladire propusa
- cladiri existente
- spatii verzi
- terase, platforme
- terase, acoperite
- alei pietonale
- alei carosabile
- ziduri fara ferestre

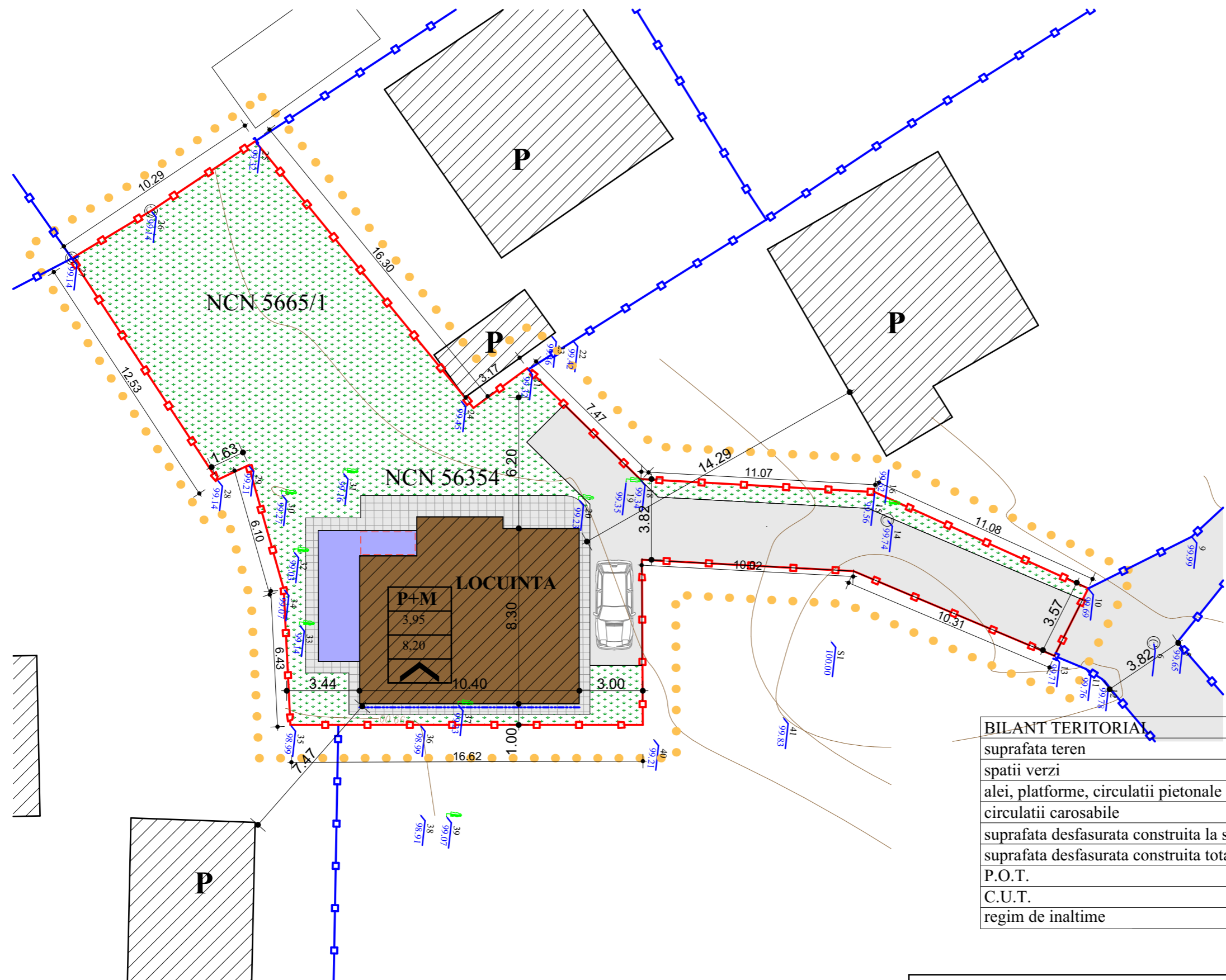

BILANT TERITORIAL	existent	procent	propus	procent
suprafata teren	500,00	100%	500,0	100%
spatii verzi	500,0	100%	256,5	51,30%
alei, platforme, circulatii pietonale	0.00		58.0	11,60%
circulatii carosabile	0.00		96,5	19,30 %
suprafata desfasurata construita la sol Sc	0.00		89,0	17,8 %
suprafata desfasurata construita totala SD	0.00		178,0	
P.O.T.	0.00%		18,0%	
C.U.T.	0.00		0,36	
regim de inaltime	-		P+M	

PROIECTANT GENERAL



**SOCIETATEA COMERCIALA
PROIECT
BOTOSANI
S.R.L.**
SC "PROIECT BOTOSANI" SRL
BOTOSANI, Str. Cuza Voda Nr. 2, Bl.7, Sc. F, Mezanin
tel/fax: 0231-514965; cf : 4906270;
r.c. j07/1086/1993

BENEFICIAR:
PRIMARIA MUN. BOTOSANI

INVESTITOR:
HAIDAU ELENA CAMELIA

Pr.Nr.
1892/ 2015

SPECIFICATIE	NUME	SEMNATURA	Scara
SEF PROIECT	arh.M.TULBURE		1:200
COORDONATOR	arh.M.TULBURE		
PROIECTAT	arh. C. HARALAMB		
DESENAT	arh. C. HARALAMB		





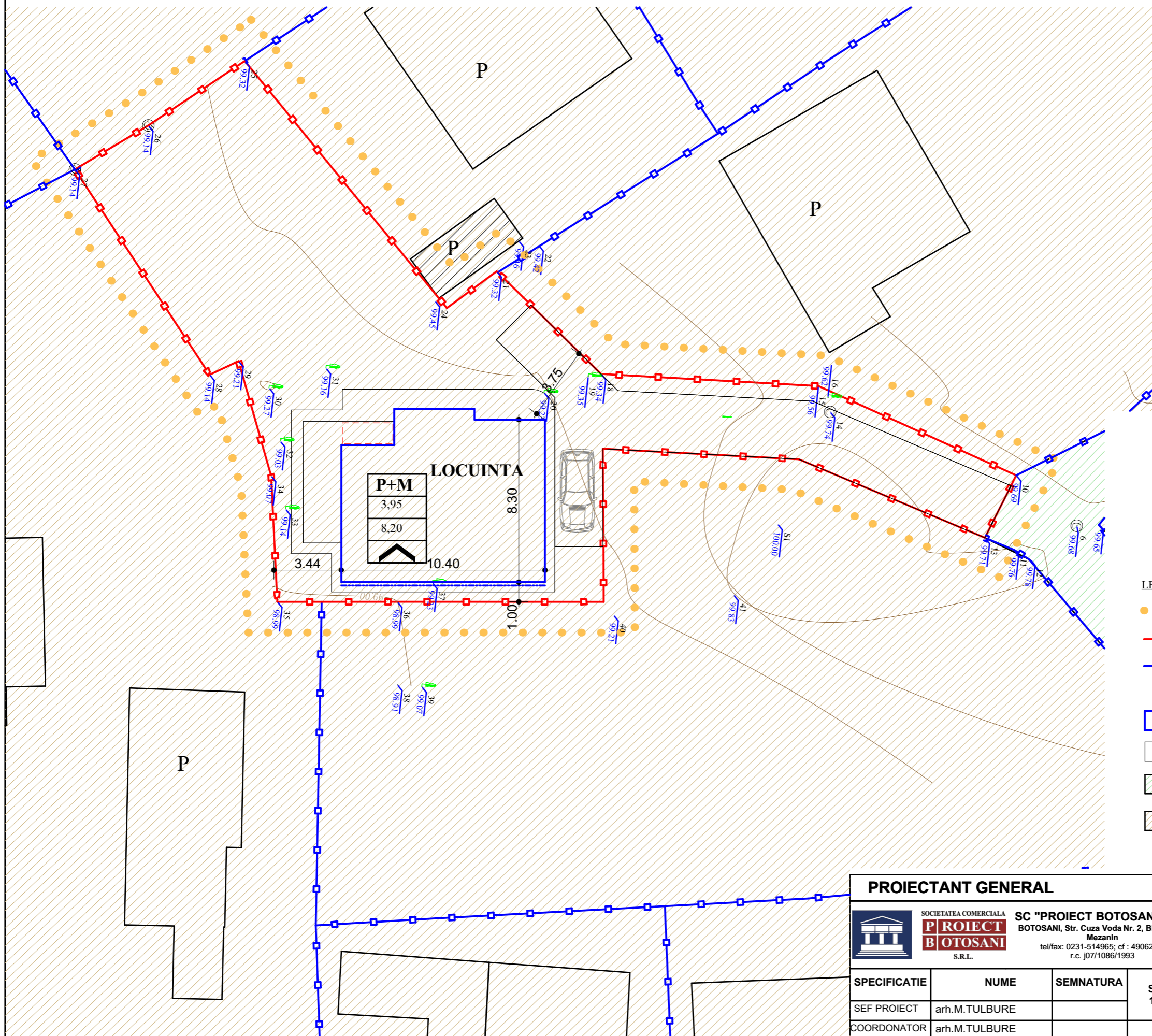
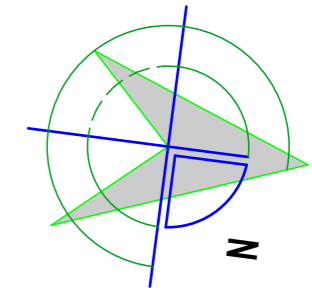

PROIECT:	FAZA:
CONSTRUIRE LOCUINTA P+M	P.U.D.
STR. BUCOVINA NR.54 MUN. BOTOSANI	PLANSĂ NR. A3
TITLU PLANSA:	
REGLEMENTARI URBANISTICE	

P.U.D.

CONSTRUIRE LOCUINTA P+M



LEGENDA

-  limita zonei studiate
-  limita de proprietate Haidau Elena-Camelia
-  limita de proprietate pers. fizice sau juridice
-  cladire propusa
-  cladiri existente
-  teren proprietate privata persoane fizice sau juridice din care: propr. Haidau Elena 500.0 mp
-  domeniu public- proprietatea mun. Botosani

PROIECTANT GENERAL



SOCIETATEA COMERCIALA
PROIECT BOTOSANI
S.R.L.
SC "PROIECT BOTOSANI" SRL
BOTOSANI, Str. Cuza Voda Nr. 2, Bl.7, Sc. F, Mezanin
tel/fax: 0231-514965; cf : 4906270;
r.c. j07/1086/1993

BENEFICIAR:
PRIMARIA MUN. BOTOSANI
INVESTITOR:
HAIDAU ELENA CAMELIA

Pr.Nr.
1892/ 2015

SPECIFICATIE	NUME	SEMNATURA
SEF PROIECT	arh.M.TULBURE	
COORDONATOR	arh.M.TULBURE	
PROIECTAT	arh. C. HARALAMB	
DESENAT	arh. C. HARALAMB	

Scara
1:200

DATA
03/2015

PROIECT:
CONSTRUIRE LOCUINTA P+M
STR. BUCOVINA NR.54 MUN. BOTOSANI
TITLU PLANSA:
CIRCULATIA TERENURILOR

FAZA :
P.U.D.
PLANSA NR.
A4

P.U.D.

CONSTRUIRE LOCUINTA P+M

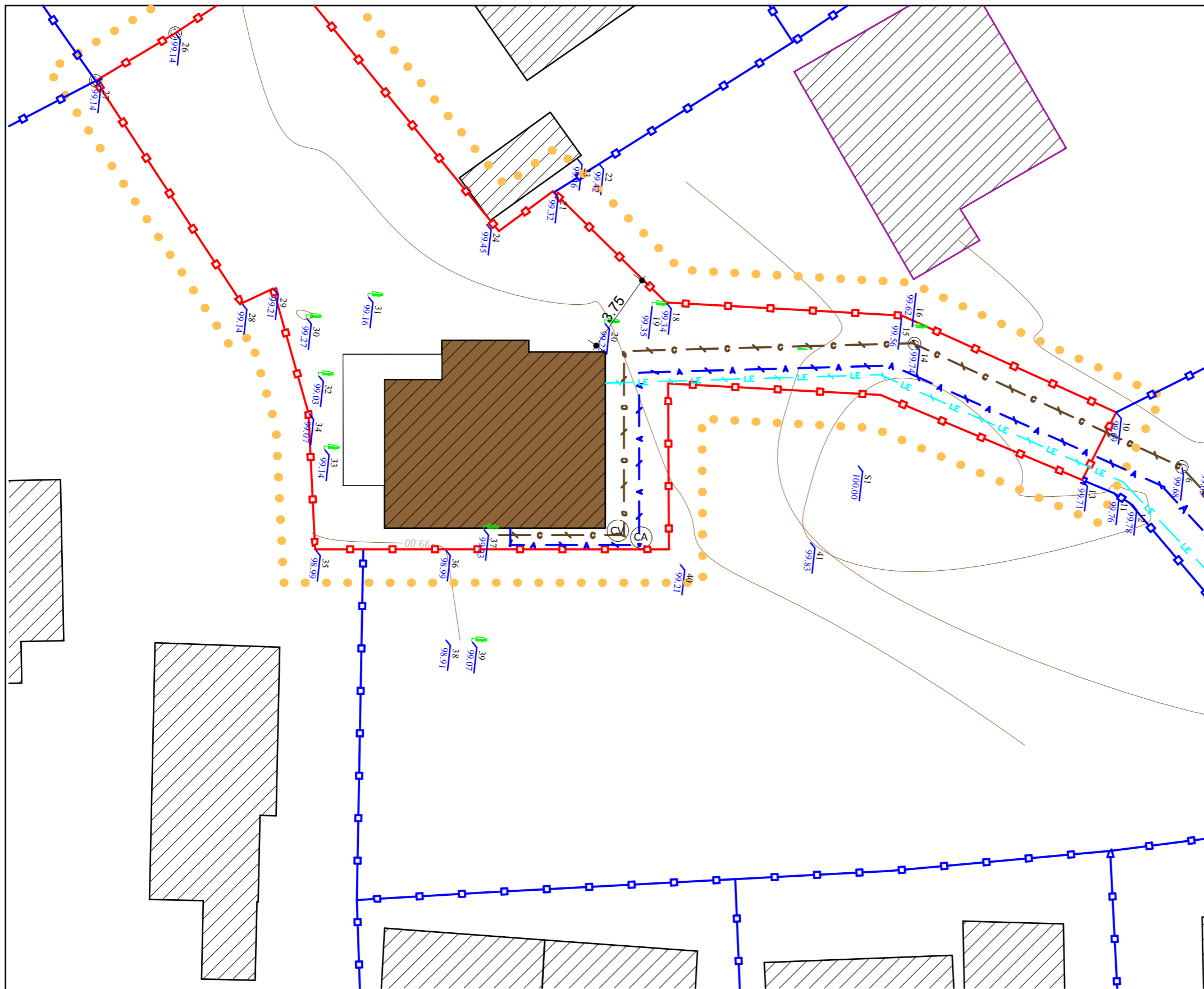

LEGENDA

- limita zonei studiate
- limita de proprietate Haidau Elena
- limita de proprietate pers. fizice sau juridice
- cladire propusa
- cladiri existente
- retea de apa existenta
- retea de apa propusa
- retea de canalizare existenta
- retea de canalizare propusa
- retea electrica existenta
- retea electrica propusa
- camin vane
- camin vizitare

PROIECTANT GENERAL



SOCIETATEA COMERCIALA
PROIECT BOTOSANI
S.R.L.

SC "PROIECT BOTOSANI" SRL
BOTOSANI, Str. Cuza Voda Nr. 2, Bl.7, Sc. F, Mezanin
tel/fax: 0231-514965; cf : 4906270;
r.c. j07/1086/1993

BENEFICIAR:
PRIMARIA MUN. BOTOSANI

INVESTITOR:
HAIDAU ELENA CAMELIA

Pr.Nr.
1892/ 2015

SPECIFICATIE	NUME	SEMNATURA	Scara 1:200
SEF PROIECT	arh.M.TULBURE		DATA 03/2015
COORDONATOR	arh.M.TULBURE		
PROIECTAT	arh. C. HARALAMB		
DESENAT	arh. C. HARALAMB		

PROIECT:
CONSTRUIRE LOCUINTA P+M
STR. BUCOVINA NR.54 MUN. BOTOSANI

TITLU PLANSA:
REGLEMENTARI EDILITARE

FAZA :
P.U.D.

PLANSA NR.
A5

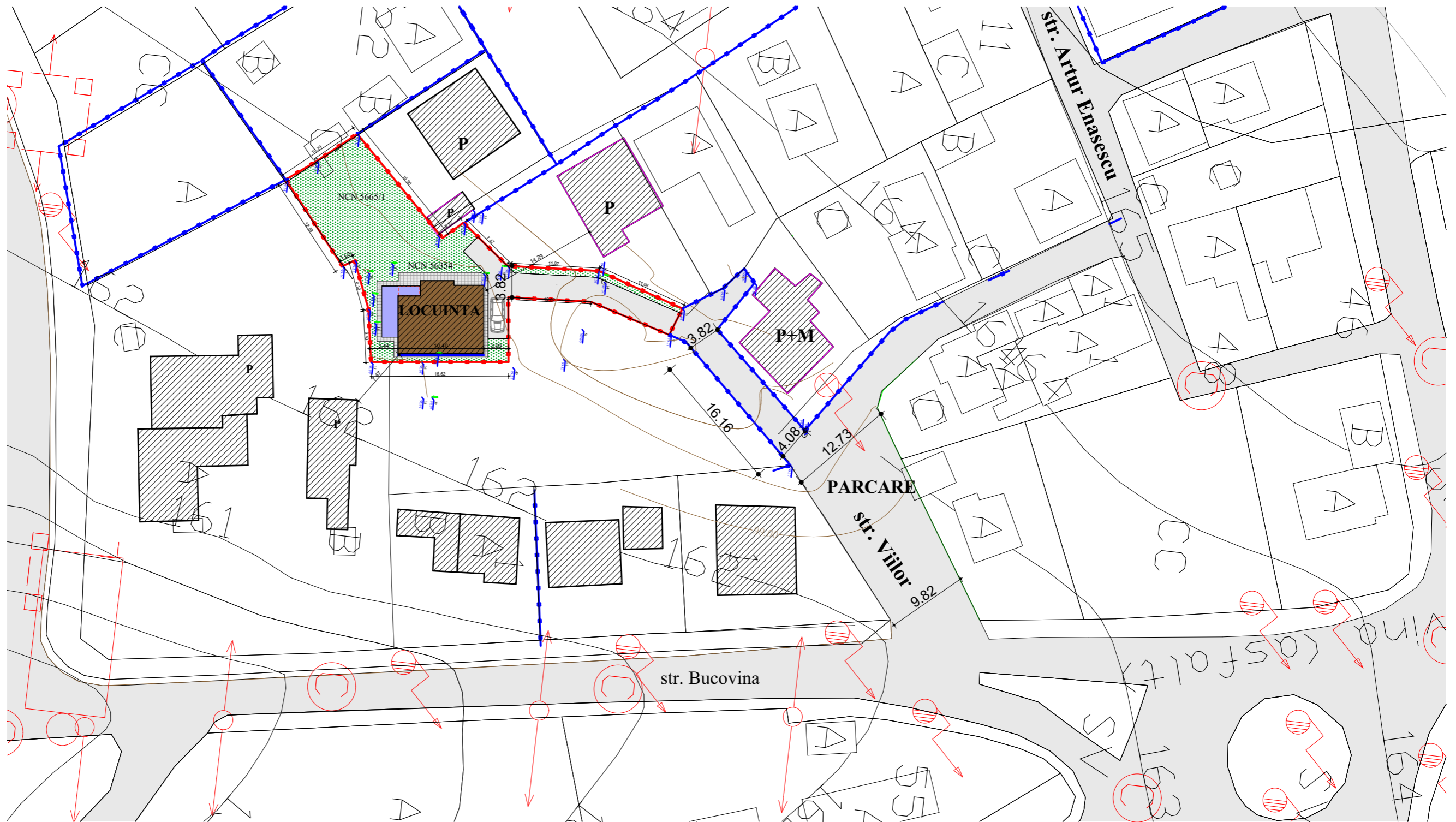

<p align="center">PROIECTANT GENERAL</p>  <p>SOCIETATEA COMERCIALA PROIECT BOTOSANI S.R.L.</p>				<p>SC "PROIECT BOTOSANI" SRL BOTOSANI, Str. Cuza Voda Nr. 2, Bl.7, Sc. F, Mezanin tel/fax: 0231-514965; cf : 4906270; r.c. j07/1086/1993</p>		<p>BENEFICIAR: PRIMARIA MUN. BOTOSANI</p> <p>INVESTITOR: HAIDAU ELENA CAMELIA</p>		<p align="center">Pr.Nr. 1892/ 2015</p>	
<p>SPECIFICATIE</p>		<p>NUME</p>		<p>SEMNATURA</p>		<p>Scara 1:200</p>		<p>PROIECT: CONSTRUIRE LOCUINTA P+M STR. BUCOVINA NR.54 MUN. BOTOSANI</p>	
<p>SEF PROIECT</p>		<p>arh.M.TULBURE</p>		<p>COORDONATOR</p>		<p>arh.M.TULBURE</p>		<p align="center">FAZA : P.U.D.</p>	
<p>PROIECTAT</p>		<p>arh. C. HARALAMB</p>		<p>DESENAT</p>		<p>arh. C. HARALAMB</p>		<p align="center">TITLU PLANSA: PLAN ACCESE LA PARCELA</p>	
				<p>DATA 03/2015</p>				<p align="center">PLANSA NR. A6</p>	