

P . U . D . - P L A N U R B A N I S T I C D E D E T A L I U

FORMAT: A3

LEGENDĂ	
	--- Statie Topografica
	--- Camin de Vizitare
	--- Hidrant
	--- Gaz
	--- Cutie Gaze
	--- Indicator
	--- Linie Electrica Subterana
	--- Contor - Curent Electric
	--- Stalp , pentru lumina electrica , din beton
	--- Stalp din Metal
	--- Stalp Iluminator
	--- Semafor Rutier
	--- Panou publicitar
	--- Banca
	--- Cos gunoi
	--- Stalp lemn
	--- Podet
	--- Scari
	--- Constructie
	--- Beton sau Platforma Betonata
	--- Copac
	--- Drum
	--- Ax Drum
	--- Gard din Beton
	--- Trotuar pavat
	--- Zid de Beton
	--- Liniã Tramvai
	--- Bordura
	--- Gard Viu
	--- Troiã
	--- Stalp beton

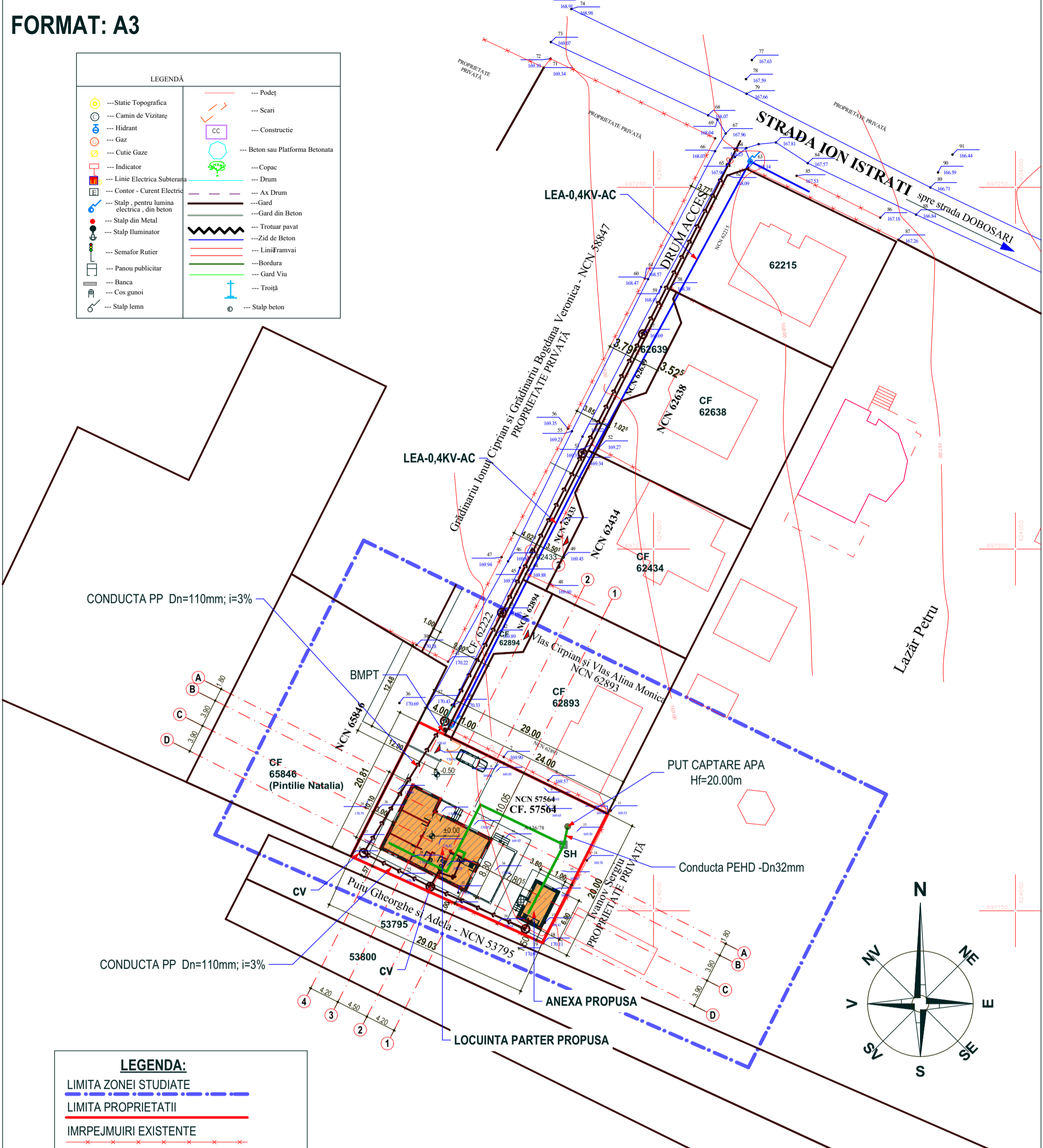

LEGENDA:	
	LIMITA ZONEI STUDIATE
	LIMITA PROPRIETATII
	IMRPEJMUIRI EXISTENTE
	CLADIRI EXISTENTE
	CONSTRUCTII PROPUSE
	RETELE ELECTRICE
	RETELE ALIMENTARE APA
	RETELE CANALIZARE MENAJERA
	SH □ -STATIE HIDROFOR
	CV CAMIN DE VIZITARE

Director : c.Arh. CARMEN DIMITROPOL			
verificator/ expert	nume	semnatura	cerinta
SC ARHIMONDIA PROIECT S.R.L.-CUI: 23650193, J07/236/03.04.2008			
specificatie	nume	semnatura	scara
coordonator	Arh.Urb.Monica Bacinschi		1/500
sef proiect	c.Arh.Sebastian. Dimitropol		data: SEP. 2018
proiectat	ing. A. Florea		
desenat	c.Arh.Carmen Dimitropol		

BUCURESTI: Str.W.A.Mozart nr.6, sector 2 tel: 0744.916.586 0732.649.689	BOTOSANI: Str. Octav Bancila nr.2 tel: 0751.420.947
sebastianarh@yahoo.com	carmenarhitect@yahoo.com
referat /expertiza nr./ data	
SAUCA IULIAN si TROI ALINA	
CONSTRUIRE LOCUINTA PARTER, ANEXA GOSPODAREASCA, ÎMPREJMUIRE TEREN SI RACORDURI UTILITATI ALEEA ION ISTRATI NR.5E, NC.56574 CF.56574, NC.2100/2/1/8 CF.56373, NC.2100/2/1/6 CF.62222	
proiect nr: 150/2018	faza: P.U.D.
REGLEMENTARI EDILITARE	
plansa nr. U5	