







P.U.D.

CASA

2206/2022

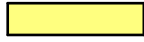
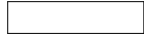
Strada Drumul Tatarilor 67E

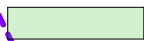
LEGENDA

-  LIMITA ZONA STUDIATA
-  LIMITA PROPRIETATE 808.00mp
-  CONSTRUCTII PROPUSE 150.50mp
-  ALEI SI TROTUARE 28.74mp
-  CAROSABIL PARCARI 86.14mp  
din care 22.70mp drum - retragere imprejmuire
-  SPATII VERZI AMENAJATE 542.62mp
-  IMPREJMUIRE TEREN 133.11ml

ACCES PRINCIPAL

S.T. = 808.00mp; A.C. = 150.50mp; A.D.C. = 245.50mp

P.O.T. = 18.63%

C.U.T. = 0.304

h soclu: - 0.60 / - 1.50  
 h cornisa: + 4.50  
 h coama: + 7.90

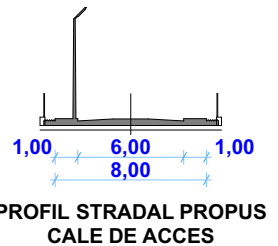
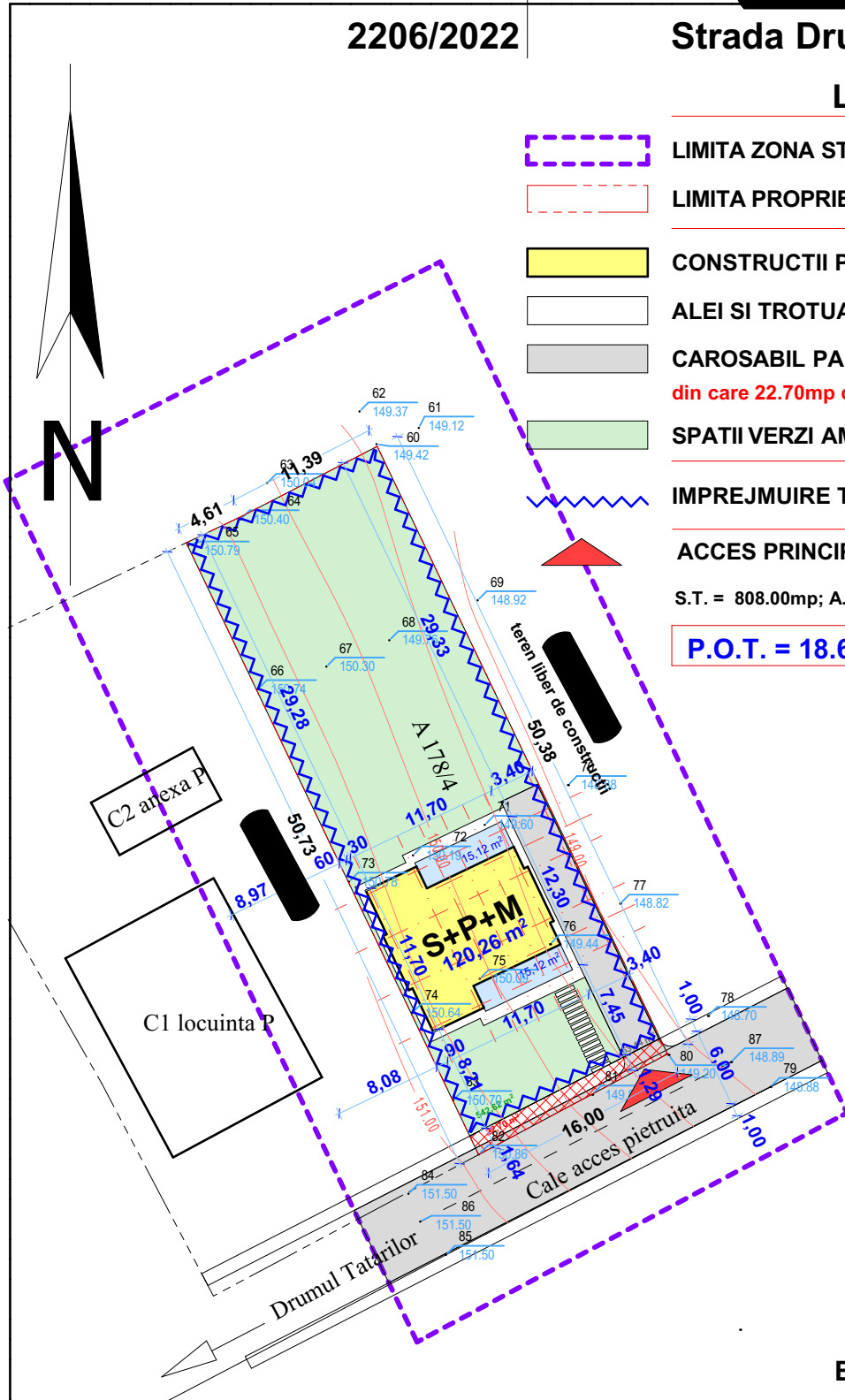

BILANT TERITORIAL

	EXISTENT		PROPUS	
	mp	%	mp	%
S. PARCELA STUDIATA	808.00	100.00 %	808.00	100.00 %
S. CONSTRUCTII	0.00	0.00 %	150.50	18.63 %
S. ALEI TROTUARE	0.00	0.00 %	28.74	3.57 %
S. CAROSABIL PARCARI	0.00	0.00 %	86.14	10.65 %
S. SPATII VERZI	808.00	100.00 %	542.62	67.15 %

coordonator urbanism arh.dan o.botez

S.C. "CASA CHIRIAC" S.R.L.  
 BOTOSANI  
 R.C.J. J07 / 372 / 1992 - TEL. 0744.700798  
 sef proiect: c.arh.marcel d.chiriac .....  
 proiectat: c.arh.marcel d.chiriac .....  
 procesat: c.arh.marcel d.chiriac .....

beneficiar: .....  
 proiect: CONSTRUIRE LOCUINTA S+P+M SI IMPREJMUIRE  
 Strada Drumul Tatarilor Nr. 67E - Botosani  
 REGLEMENTARI URBANISTICE  
 scara: 1/500  
 sep.2022

2206/2022  
 faza:  
 P.U.D.