

# P.U.D.

## CONSTRUIRE LOCUINTA P+1E, ANEXA GOSPODAREASCA (S+P), IMPREJMUIRE TEREN

strada DOBOSARI, nr. 81, Botosani, NC/CF 61839

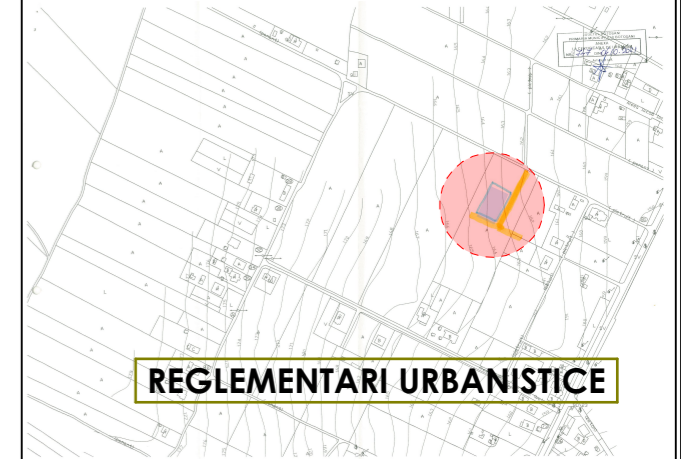

### REGLEMENTARI URBANISTICE

- \*— 1000 mp - limita proprietate
- CF 61839
- 160 mp locuinta propusa P+1E
- 32 mp anexa gosp. propusa S+P
- 150 mp suprafata pietonala - alei, terase neacoperite
- 45 mp suprafata carosabila
- 613 mp spatiu verde
- — — — — imprejmuire existenta
- — — — — imprejmuire propusa
- — — — — constructii existente in afara limitei de proprietate
- — — — — supr. pietonala pe calea de acces CF 50662
- — — — — supr. carosabila pe calea de acces CF 50662
- ▲ bordura inclinata - racord carosabil
- ▲ acces carosabil
- ▲ acces pietonal
- ▨ zona edificabila conform CU nr. 747 din 04.10.2021

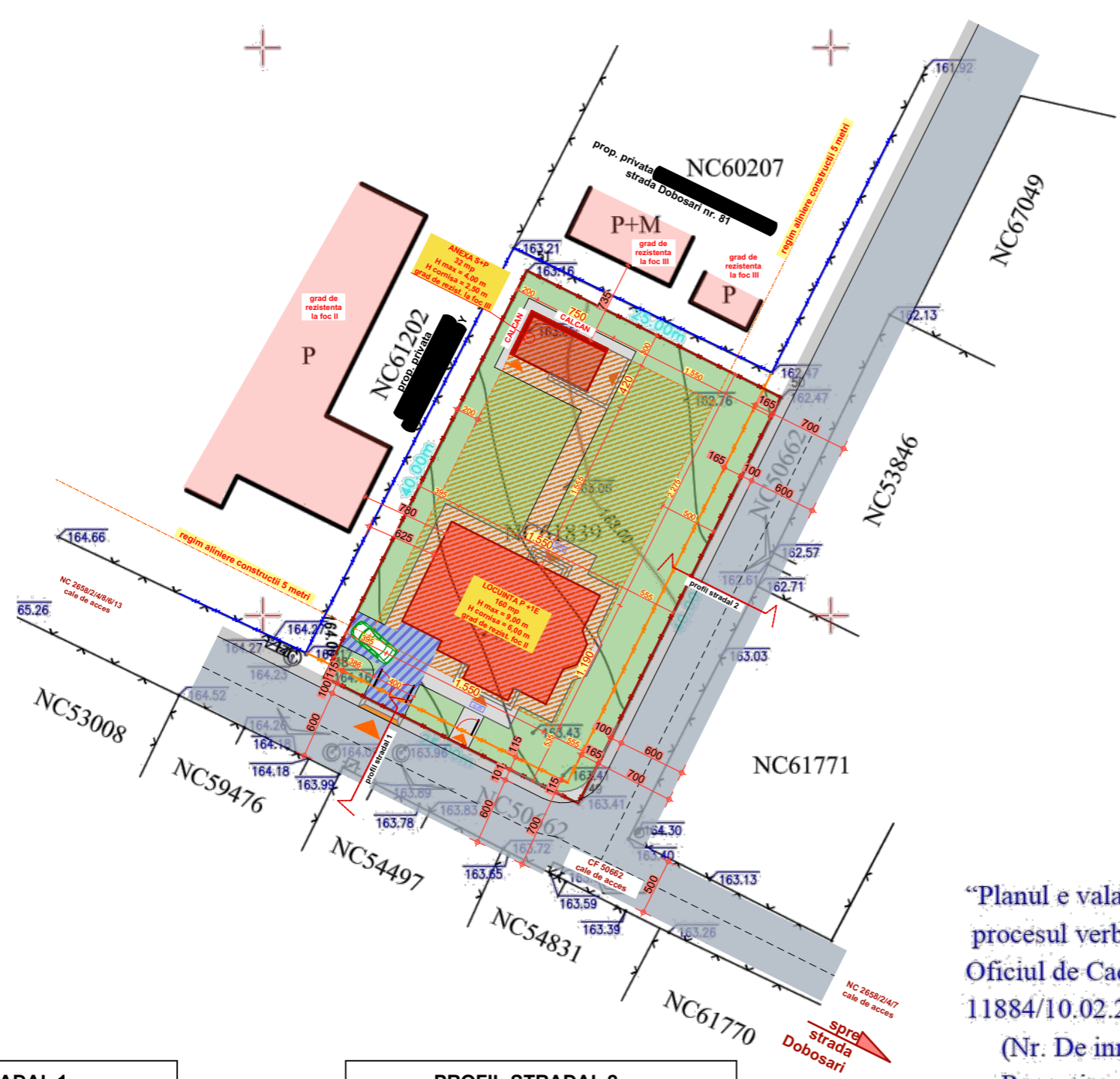

“Planul e valabil numai  
procesul verbal de rec  
Oficiul de Cadastru si  
11884/10.02.2022

(Nr. De inregistrare  
Receptionat. Inspec

### INDICATORI URBANISTICI

$$POT = \frac{Sc}{St} \times 100 = \frac{192 \times 100}{1000} = 19,20\%$$

$$CUT = \frac{Sdc}{St} = \frac{347}{1000} = 0,35$$

### BILANT TERITORIAL PROPOS

SUPRAFATA TEREN	1000 mp	100%
1. Suprafata constr. locuinta P+E Sc desfasurata = 283 mp Suprafata constr. anexa S+P Sc desfasurata = 64 mp	160 mp 32 mp	19,20%
2. Circulatii pietonale	150 mp	15,00%
3. Circulatii carosabile	45 mp	4,50%
4. Spatii verzi	613 mp	61,30%

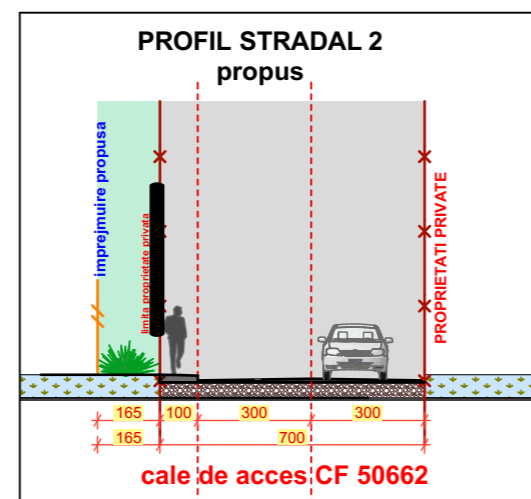
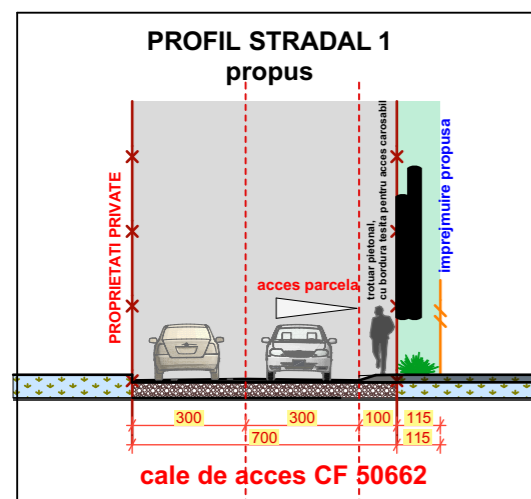

coordonator urbanism	arh. urb. Tulbure Mihai	nume	semnatura		
		BOTOSANI, Str. Unirii, Nr. 7, Sc. B, ap. 14 tel: 0745-362577; CIF : 41729555		BENEFIICIAR: 	
SPECIFICATIE	NUME	SEMNTURA	Sc.	PROIECT: CONSTRUIRE LOCUINTA P+1E, ANEXA GOSPODAREASCA (S+P), IMPREJMUIRE TEREN	
SEF PROIECT	arh. Sorana TULBURE		1:500	strada DOBOSARI nr.81, mun. Botosani CF 61839	
PROIECTAT	arh. Sorana TULBURE		DATA 2022	REGLEMENTARI URBANISTICE	
DESENAT	arh. Sorana TULBURE			FAZA : P.U.D.	
				PLANSA NR. A03	