







**P.U.D.**

**CASA**

**2206/2022**

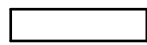
**Strada Drumul Tatarilor 67E**

**LEGENDA**

-  **LIMITA ZONA STUDIATA**
-  **LIMITA PROPRIETATE** 808.00mp
-  **CONSTRUCTII PROPUSE** 150.50mp
-  **TEREN PROPRIETATE PRIVATA**  
 CONTRACT DE VINZARE CUMPARARE NR. 82 /07.02.2022  
 din care 22.70mp drum - retragere imprejmuire
-  **IMPREJMUIRE TEREN** 133.11ml
-  **ACCES PRINCIPAL**

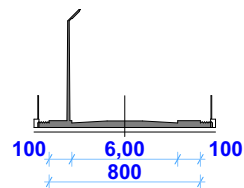
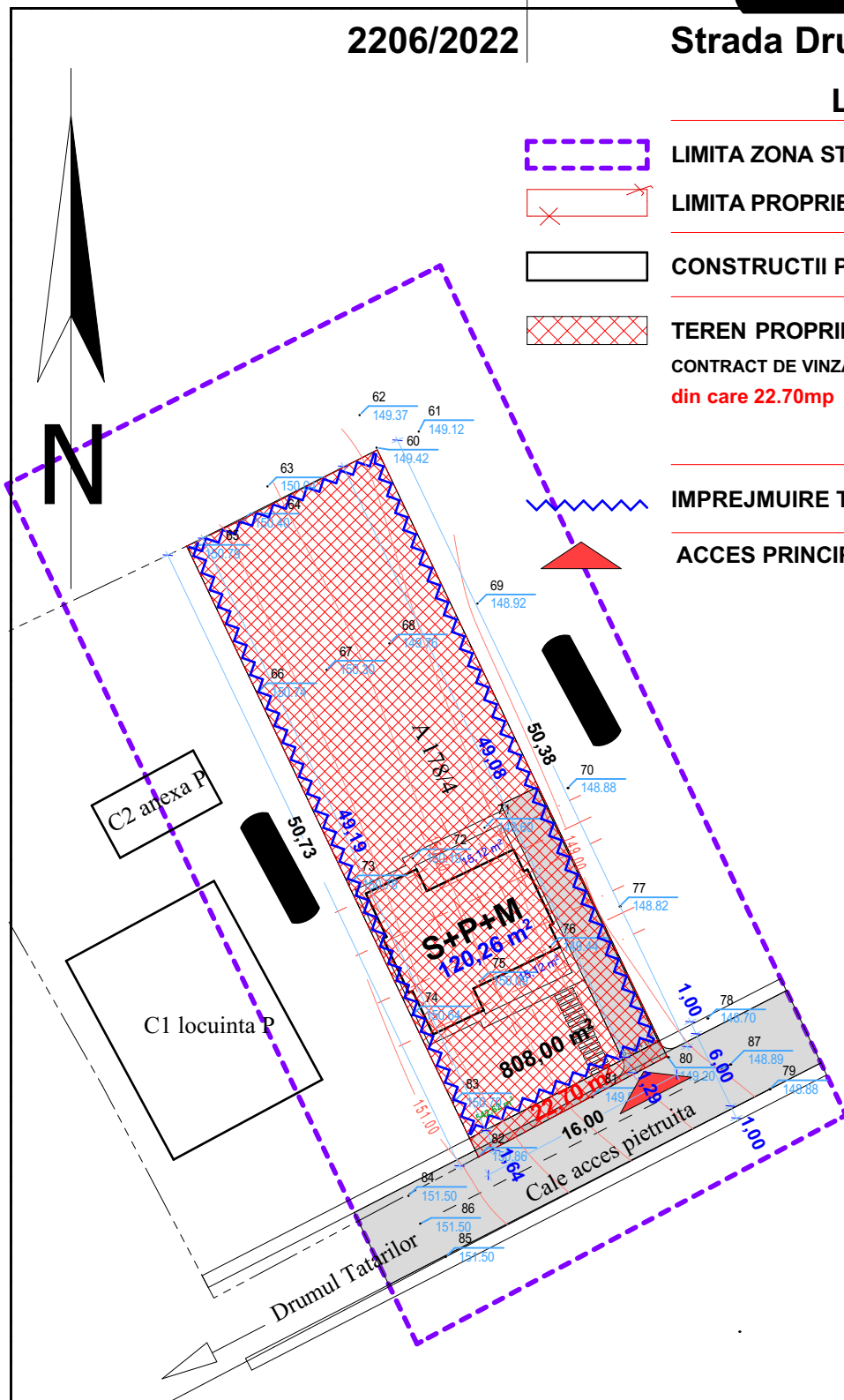

**PROFIL STRADAL PROPUSE  
CALE DE ACCES**

coordonator urbanism arh.dan o.botez

**S.C. "CASA CHIRIAC" S.R.L.  
BOTOSANI**  
R.C.J. J07 / 372 / 1992 - TEL. 0744.700798

sef proiect: c.arh.marcel d.chiriac .....  
 proiectat: c.arh.marcel d.chiriac .....  
 procesat: c.arh.marcel d.chiriac .....

beneficiar: [redacted]  
 proiect: **CONSTRUIRE LOCUINTA S+P+M SI IMPREJMUIRE**  
 Strada Drumul Tatarilor Nr. 67E - Botosani

scara:  
1/500  
sep.2022

**SITUATIA TERENURILOR**

2206/2022  
faza:  
P.U.D.