

# P.U.Z. PLAN URBANISTIC ZONAL

## SITUATIA EXISTENTA

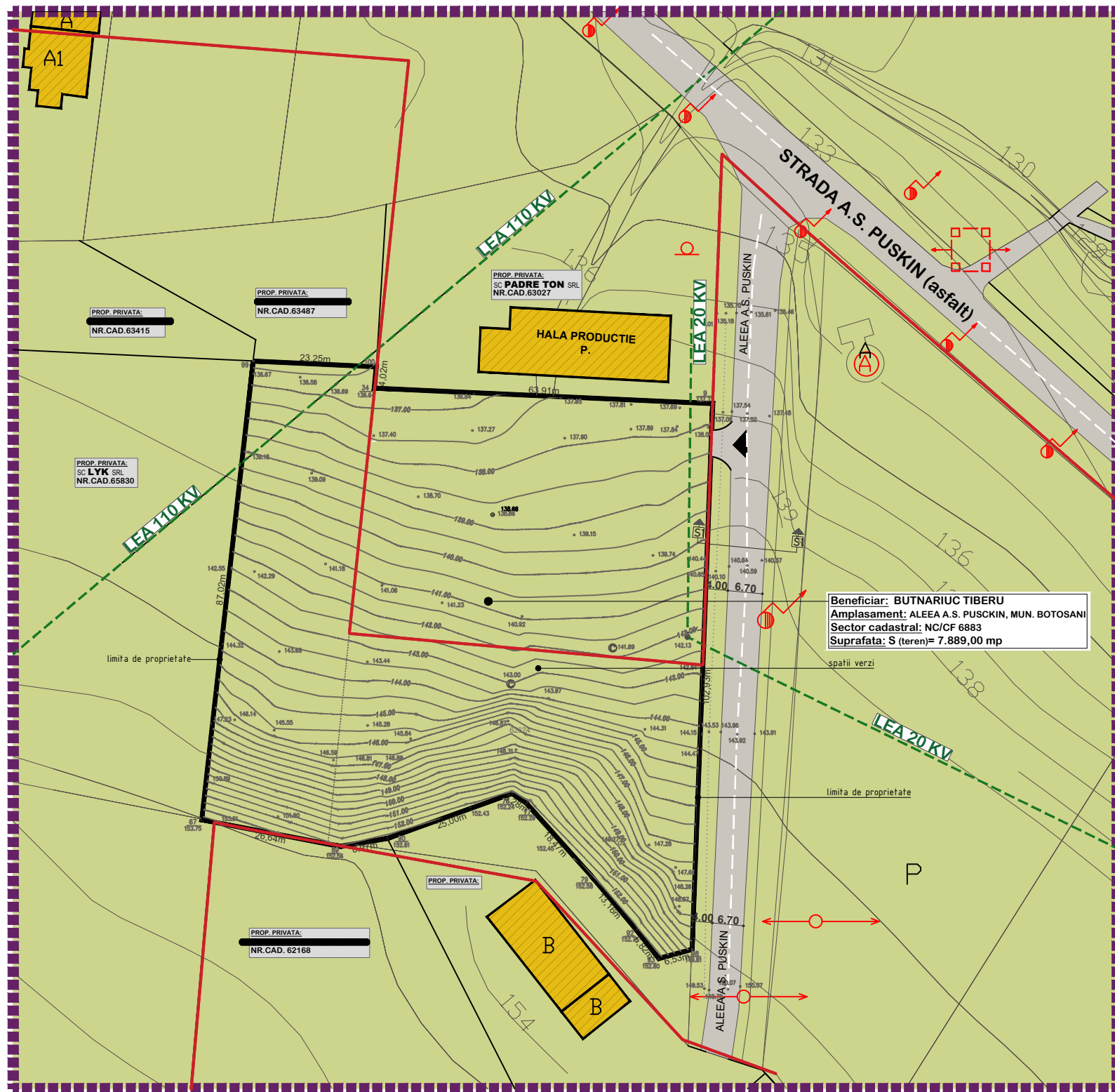
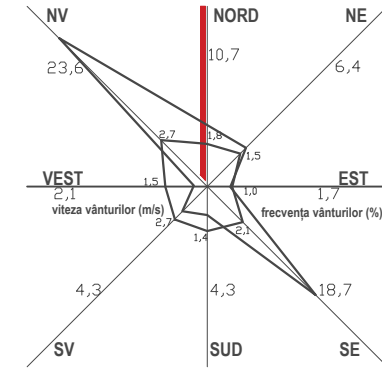

### CAI DE COMUNICATII:

ACCES CARASABIL - aleea A.S. PUSKIN

### LIMITE:

- LIMITA PROPRIETATE/PARCELA CARE FACE OBIECTUL DOCUMENTATIEI NC/CF 68883; S=7.889,00 mp
- LIMITA ZONEI STUDIATE
- LIMITA INTRAVILAN EXISTENT

### REGLEMENTARI URBANISTICE:

- CIRCULATII PUBLICE
- CONSTRUCTII EXISTENTE IN AFARA ZONEI REGLEMENTATE
- SPATII VERZI PLANTATE - (teren curtii constructii)
- ACCES AUTO PE AMPLASAMENT

UTR nr. 59, TAG - zona cu terenuri agricole

( arabil, fanete, pasune, vii, livezi )

Suprafata teren in intravilan = 3130 mp din total 7889 mp.

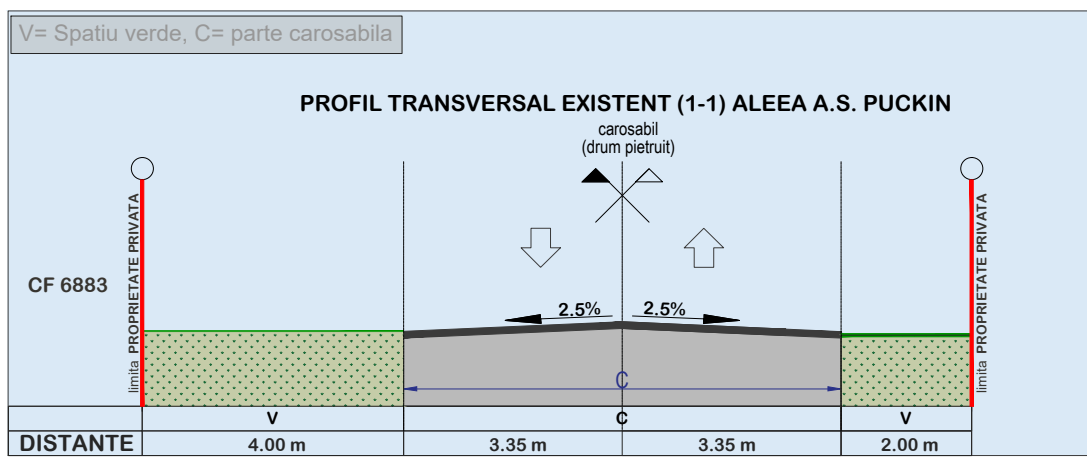

PROIECTANT GENERAL		COORDONATOR URBANISTIC		BENEFICIAR: PRIMARIA MUN. BOTOSANI		PR. NR. 248/2022
S.C. ARHITECTURAL CONCEPT S.R.L.		SC "PROIECT BOTOSANI" SRL		INVESTITOR:		
STR. DOBOSARI NR. 37 BOTOSANI TEL: 0742 215 215		CUI: 24547758 J 07/712/2008		STR. TEATRULUI NR.3A BOTOSANI TEL/FAX: 0231-514965		PROIECT: INTRODUCERE TEREN IN INTRAVILAN SI CONSTRUIRE LOCUINTE CU REGIM MIC DE INALTIME AMPLASAMENT: STR. A. S. PUSKIN, FN, CF. 6883, MUN. BOTOSANI.
CF: 490270 R.C. J07/1086/1993	CF 6883	SEMNATURA	SCARA 1 : 1000	FAZA P.U.Z.		
ŞEF PROIECT	Arh. Tulbure Mihai	DATA	02.2022	PLANŞA NR. A2		
PROIECTAT	Arh. Prisacariu Raluca	SITUATIE EXISTENTA				
DESENAT	Th. Balan Ciprian					