

# PLAN URBANISTIC DE DETALIU

## CONSTRUIRE LOCUINTA

Subsol partial + Parter si Imprejmuire teren  
CF 60006, Str. Drumul Tatarilor nr. 9A,  
Municipiul Botosani

### COORDONATE GEOGRAFICE:

47°44'24.3"N  
26°41'38.5"E

(COORDONATE GEOGRAFICE PENTRU  
VERIFICARE SI IDENTIFICARE TEREN - AVIZE  
SI ACORDURI)

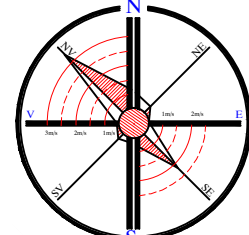
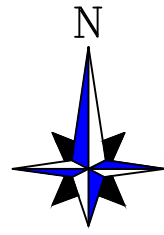

### LEGENDA:

#### 1.a. LIMITE

- Limita zonei studiate (la o distanta de 10.00 ml de la limita de proprietate)=1000.00mp
- Limita de proprietate
- Limita de proprietate (proprietati vecine)

#### 1. b. DOMENIU PUBLIC SAU PRIVAT

- Strada Drumul Tatarilor nr. 9A, mun. Botosani, strada cu imbracaminte asfaltica de tip asfalt, pretabil la trafic greu; cu trotuare si spatii verzi / rigole, acces auto existenti cu bordura inclinata

### COORDNATE STEREO 80

X=626682.368 Y=696214.113  
X=626682.515 Y=696213.909  
X=626680.637 Y=696208.705  
X=626678.911 Y=696204.668  
X=626678.086 Y=696203.068  
X=626676.375 Y=696199.750  
X=626675.398 Y=696197.998  
X=626672.944 Y=696194.663  
X=626671.629 Y=696193.221  
X=626670.159 Y=696191.988  
X=626668.315 Y=696190.701  
X=626666.787 Y=696189.748  
X=626665.109 Y=696188.701  
X=626663.413 Y=696187.686  
X=626659.769 Y=696185.592  
X=626654.651 Y=696182.624  
X=626652.799 Y=696181.642  
X=626650.996 Y=696180.901  
X=626645.761 Y=696179.661  
X=626642.627 Y=696183.333  
X=626637.660 Y=696188.684  
X=626644.171 Y=696198.027  
X=626641.387 Y=696199.632  
X=626641.064 Y=696201.243  
X=626641.165 Y=696203.791  
X=626642.166 Y=696206.601  
X=626647.075 Y=696214.125  
X=626633.437 Y=696222.311  
X=626635.884 Y=696230.097  
X=626638.871 Y=696239.642  
X=626646.773 Y=696235.232  
X=626647.551 Y=696234.085  
X=626655.529 Y=696229.573  
X=626664.258 Y=696225.294  
X=626674.314 Y=696219.008

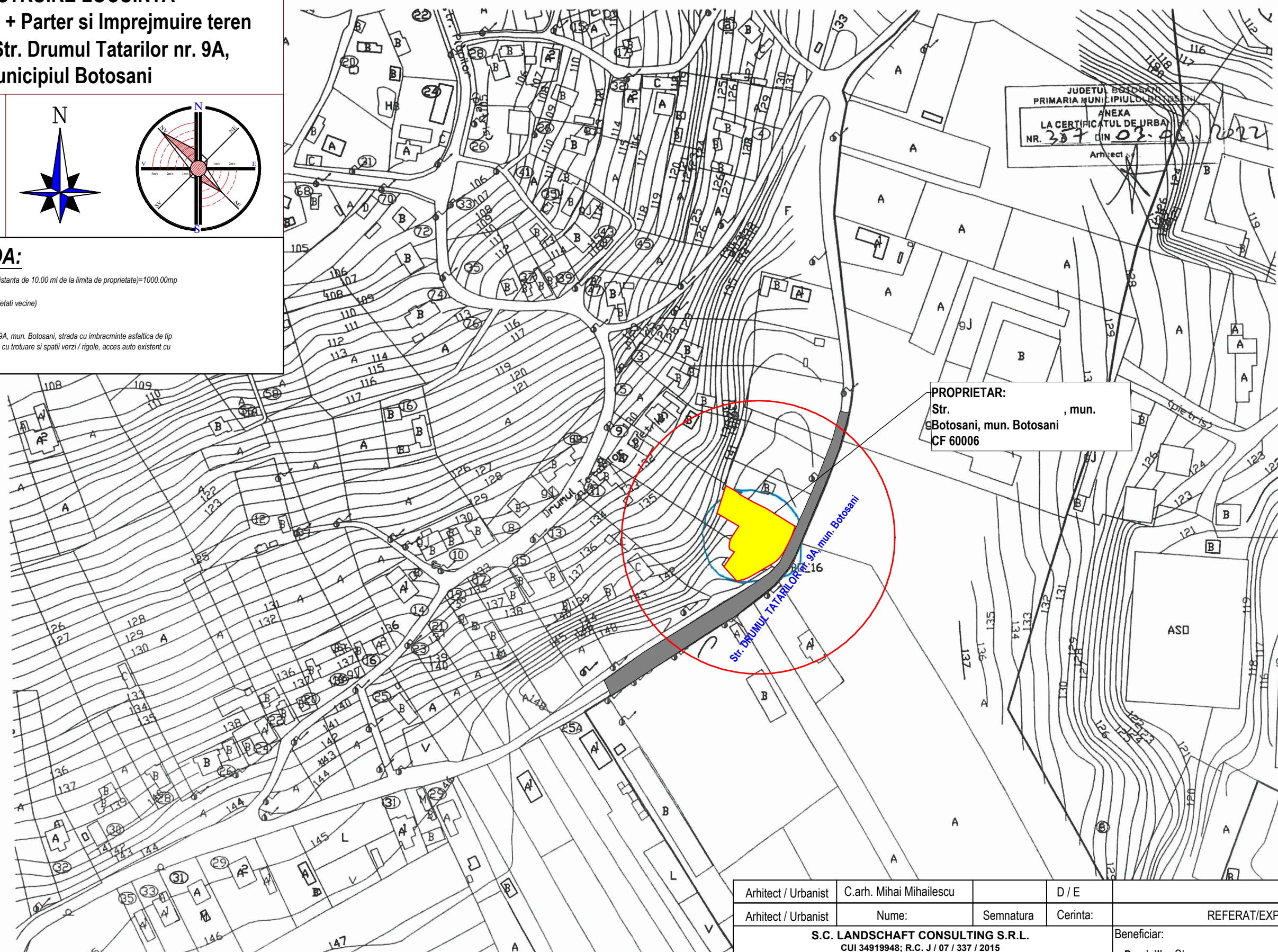

JUDETUL BOTOSANI  
PRIMARIA MUNICIPIULUI BOTOSANI  
ANEXA  
LA CERTIFICATUL DE URBA  
NR. 387 DIN 03.06.2022  
Arhitect

PROPRIETAR:  
Str. , mun.  
Botosani, mun. Botosani  
CF 60006

Arhitect / Urbanist	C.arh. Mihai Mihailescu		D / E	REFERAT/EXPERTIZA NR./DATA	
Arhitect / Urbanist	Nume:	Semnatura	Cerinta:		
<b>S.C. LANDSCHAFT CONSULTING S.R.L.</b> CUI 34919948; R.C. J / 07 / 337 / 2015 Birou: Str. Calea Nationala nr. 99, etaj 1, birou nr. 3 Tel: 0758756698; email: land_consulting@yahoo.com				Beneficiar:	Proiect Nr.
				Domiciliu: Str.	29/2022
				Municipiul Botosani	
SPECIFICATIE	NUME	Semnatura	Scara: 1:2000	Proiect: CONSTRUIRE LOCUINTA Sp+P si IMPREJMUIRE TEREN, Str. , Municipiul Botosani COD POSTAL: 710301; CF 60006	FAZA: PUD
Sef proiect:	C.arh. Mihai Mihailescu		FORMAT HARTIE A3		
Proiectat:	Arh. Elena Alina Antochi		Data: 09.2022	<b>PLAN DE INCADRARE IN ZONA</b> Str. , Municipiul Botosani COD POSTAL: 710301; CF 60006	Plansa Nr. U-00
Desenat:	Arh. Elena Alina Antochi				