

P.U.D.
1712/2017

LOCUINTA SI IMPREJMUIRE
Aleea Gheorghe Hasnas Nr.19

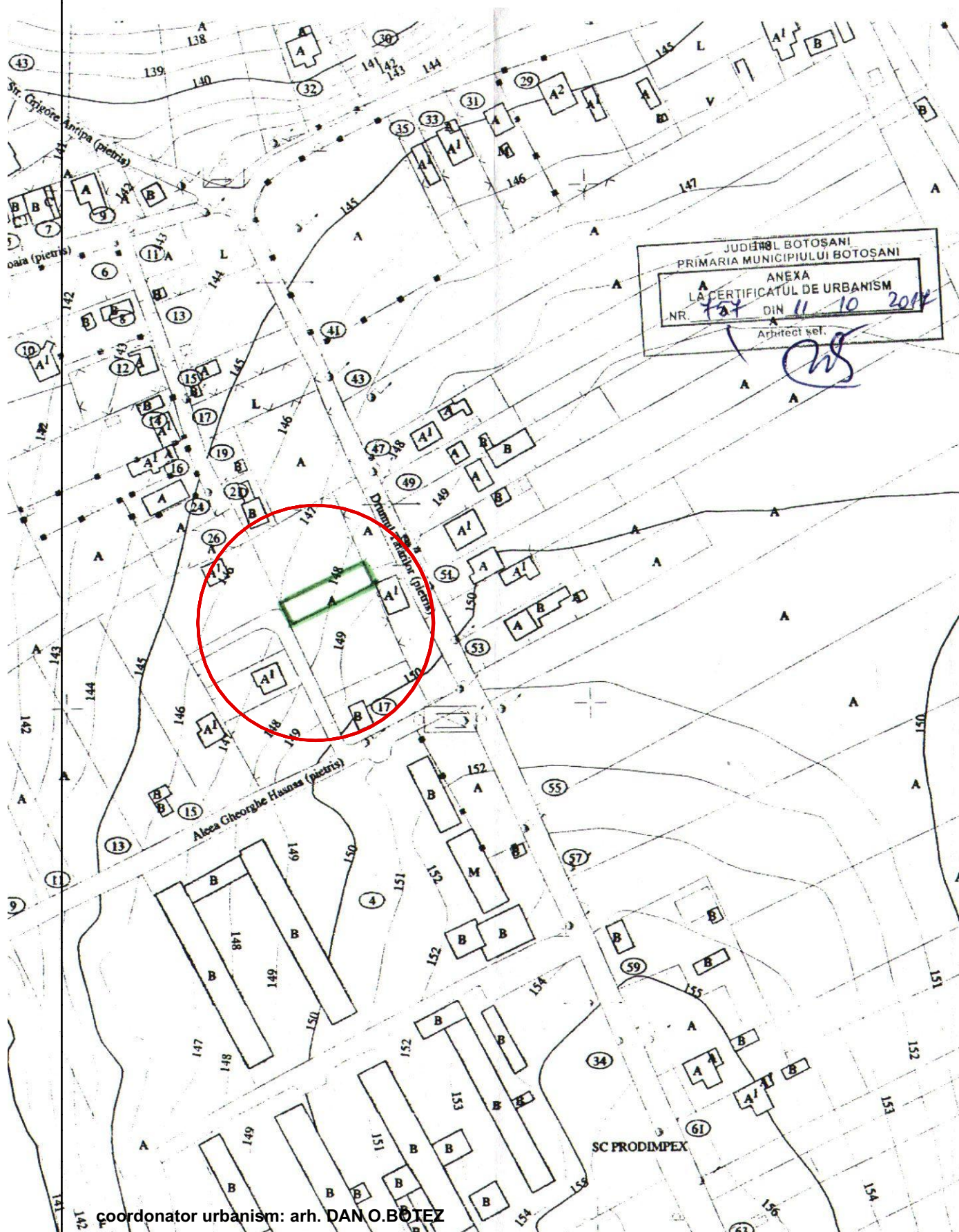

coordonator urbanism: arh. DAN O. BOTEZ

S.C. "CASA CHIRIAC" S.R.L.
BOTOSANI
R.C.J. J07 / 372 / 1992 - TEL. 0744.700798
sef proiect: c.arh.marcel d.chiriac
proiectat: c.arh.marcel d.chiriac
procesat: c.arh.marcel d.chiriac

beneficiar: **CIOCAN BOGDAN - IONEL**
proiect: **"CONSTRUIRE LOCUINTA SI IMPREJMUIRE TEREN"**
Aleea Gheorghe Hasnas Nr. 19 - Botosani
scara: **INCADRARE IN ZONA**
1/2000
oct.2017

1712/2017
faza:
P.U.D.

P.U.D.
1712/2017

LOCUINTA SI IMPREJMUIRE
Aleea Gheorghe Hasnas Nr.19

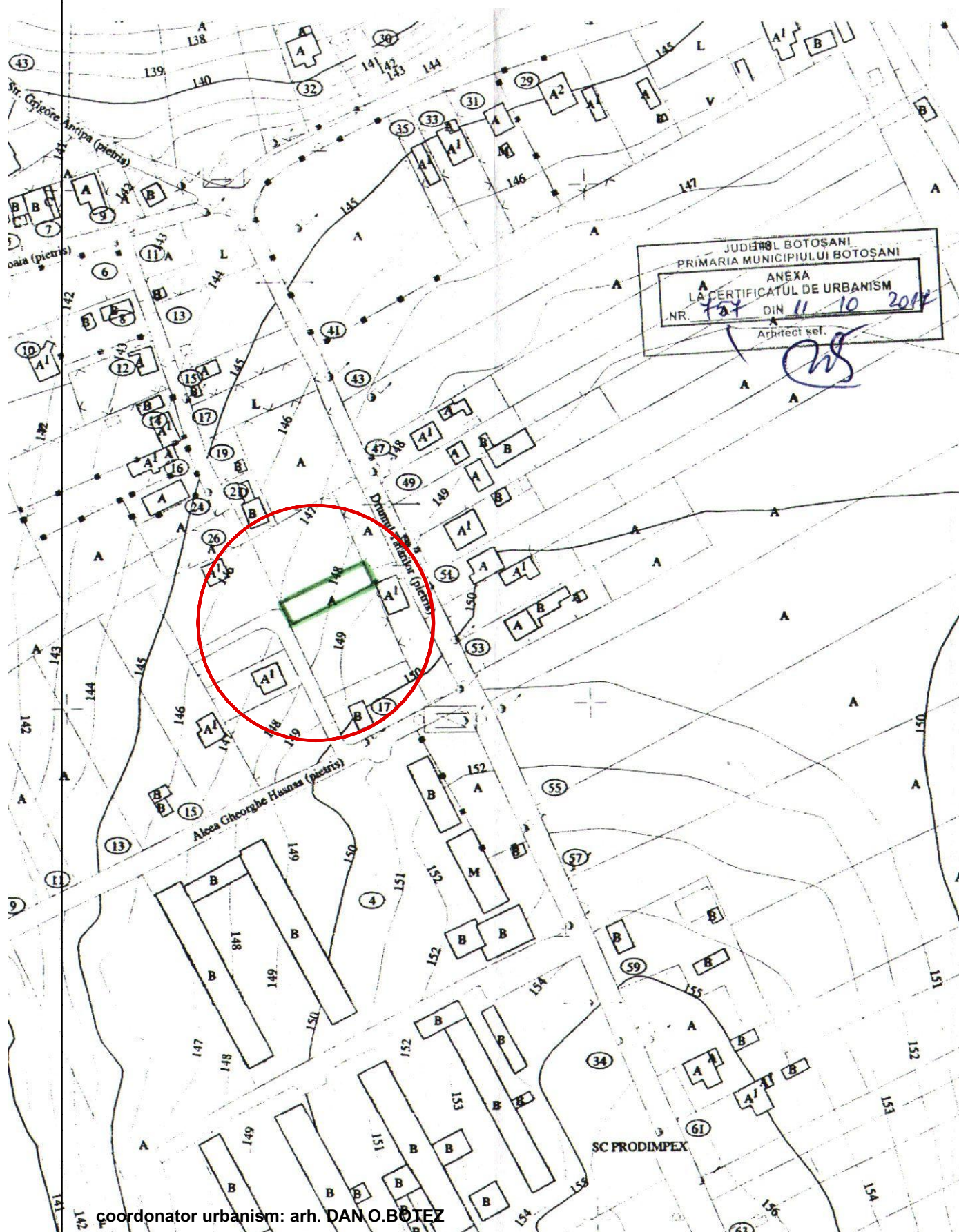

coordonator urbanism: arh. DAN O. BOTEZ

S.C. "CASA CHIRIAC" S.R.L. BOTOSANI R.C.J. J07 / 372 / 1992 - TEL. 0744.700798 sef proiect: c.arh.marcel d.chiriac proiectat: c.arh.marcel d.chiriac procesat: c.arh.marcel d.chiriac	beneficiar: CIOCAN BOGDAN - IONEL proiect: "CONSTRUIRE LOCUINTA SI IMPREJMUIRE TEREN" Aleea Gheorghe Hasnas Nr. 19 - Botosani	1712/2017 faza: P.U.D.
scara: 1/2000 oct.2017	INCADRARE IN ZONA	

P.U.D.
1712/2017

LOCUINTA SI IMPREJMUIRE
Aleea Gheorghe Hasnas Nr.19

LEGENDA

LIMITA PROPRIETATE 500.00mp
CURTI CONSTRUCTII

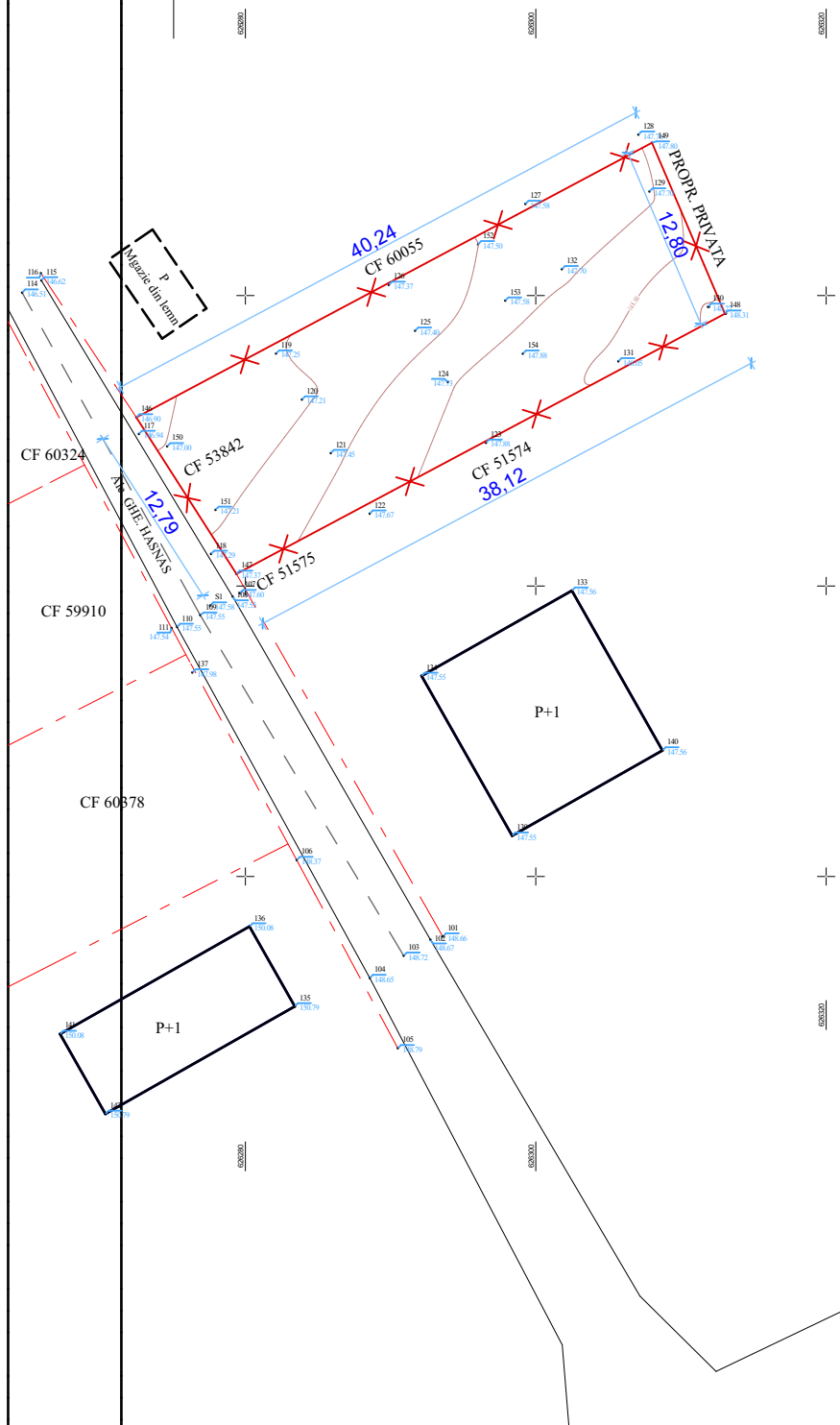

coordonator urbanism: arh. DAN O.BOTEZ

S.C. "CASA CHIRIAC" S.R.L. BOTOSANI R.C.J. J07 / 372 / 1992 - TEL. 0744.700798	beneficiar: CIOCAN BOGDAN - IONEL proiect: "CONSTRUIRE LOCUINTA SI IMPREJMUIRE TEREN" Aleea Gheorghe Hasnas Nr. 19 - Botosani	1712/2017 faza: P.U.D.
sef proiect: c.arh.marcel d.chiriac	scara: 1/500	SITUATIA EXISTENTA
proiectat: c.arh.marcel d.chiriac	oct.2017	
procesat: c.arh.marcel d.chiriac		

LEGENDA

	LIMITA PROPRIETATE	500.00mp
	CURTI CONSTRUCTII	
	CONSTRUCTII PROPUSE	90.34mp
	LOCUINTA (P+1E - partial)	81.31mp
	TERASE ACOPERITE	9.03mp
	ALEI SI TROTUARE	38.13mp
	CAROSABIL PARCARI	42.10mp
	SPATII VERZI AMENAJATE	329,43mp
	IMPREJMUIRE TEREN	104.00ml
	ACCESSE PRINCIPALE	

S.T. = 500.00mp; A.C. = 90.34mp; A.D.C. = 143.49mp

P.O.T. = 18.07%

C.U.T. = 0.287

h soclu: - 0.45
h cornisa: + 3.45
h maxim: + 7.56

acoperis intr-o apa

BILANT TERITORIAL

	EXISTENT		PROPUS	
	mp	%	mp	%
S. PARCELA STUDIATA	500.00	100.00 %	500.00	100.00 %
S. CONSTRUCTII PROPUSE	0.00	0.00 %	90.34	18.07 %
S. ALEI TROTUARE	0.00	0.00 %	38.13	7.62 %
S. CAROSABIL PARCARI	0.00	0.00 %	42.10	8.42 %
S. SPATII VERZI	500.00	100.00 %	329.43	65.89 %

coordonator urbanism: arh. DAN O.BOTEZ

S.C. "CASA CHIRIAC" S.R.L.
BOTOSANI
R.C.J. J07 / 372 / 1992 - TEL. 0744.700798
sef proiect: c.arh.marcel d.chiriac
proiectat: c.arh.marcel d.chiriac
procesat: c.arh.marcel d.chiriac









beneficiar: **CIOCAN BOGDAN - IONEL**
proiect: **"CONSTRUIRE LOCUINTA SI IMPREJMUIRE TEREN"**
Aleea Gheorghe Hasnas Nr. 19 - Botosani
scara: **1/500**
oct.2017
REGLEMENTARI URBANISTICE

1712/2017
faza:
P.U.D.

P.U.D.
1712/2017

LOCUINTA SI IMPREJMUIRE
Aleea Gheorghe Hasnas Nr.19

LEGENDA

-  LIMITA PARCELA
-  TRASEU RACORD ELECTRIC
-  bloc de masura si protectie
-  TRASEU RACORD APA
-  **camin apometru**
-  TRASEU RACORD CANALIZARE
-  **camin vizitare**
-  TRASEU RACORD GAZ

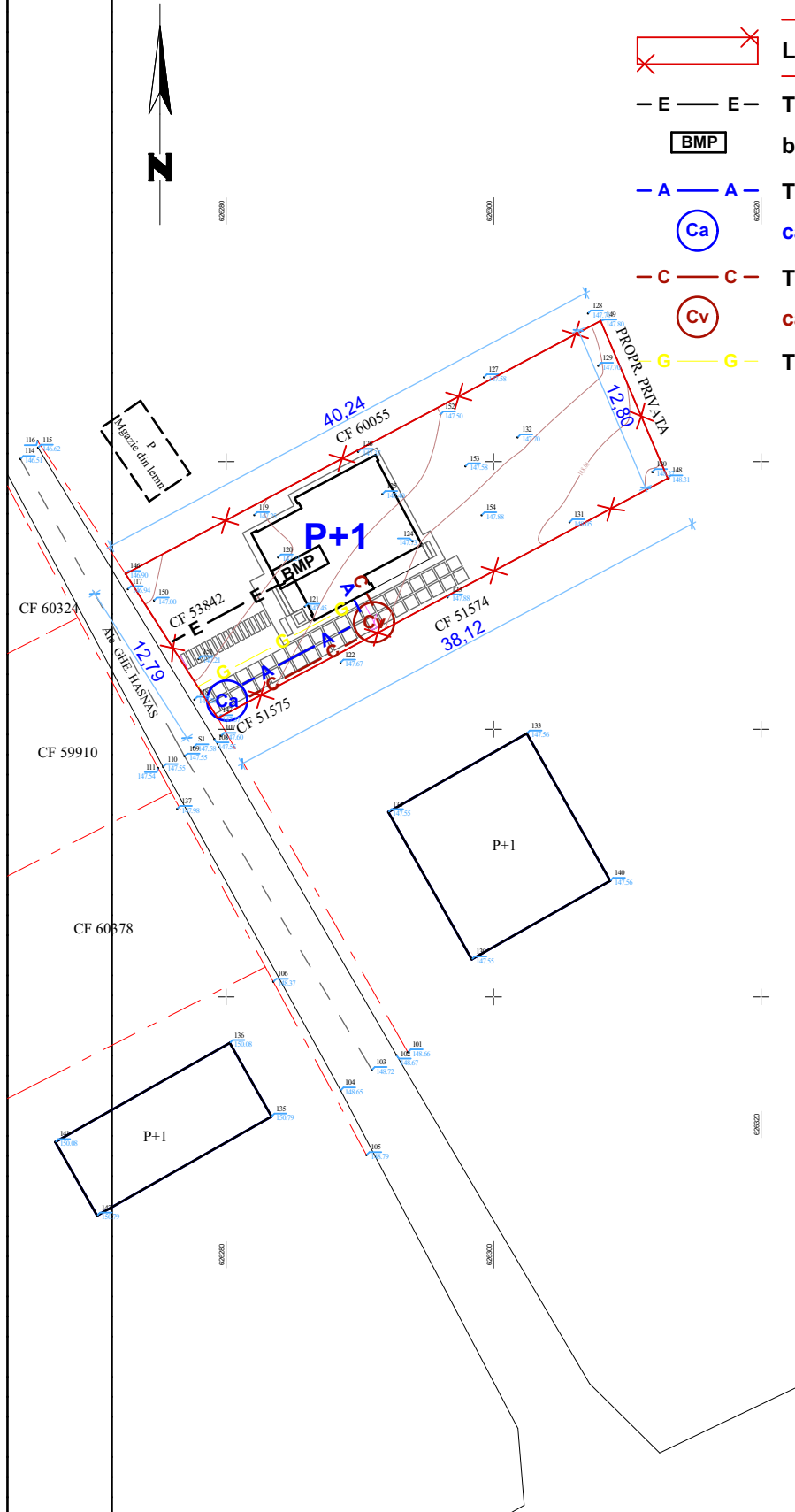

coordonator urbanism: arh. DAN O.BOTEZ

S.C. "CASA CHIRIAC" S.R.L.
BOTOSANI
R.C.J. J07 / 372 / 1992 - TEL. 0744.700798
sef proiect: c.arh.marcel d.chiriac
proiectat: c.arh.marcel d.chiriac
procesat: c.arh.marcel d.chiriac

beneficiar: **CIOCAN BOGDAN - IONEL**
proiect: "CONSTRUIRE LOCUINTA SI IMPREJMUIRE TEREN"
Aleea Gheorghe Hasnas Nr. 19 - Botosani
scara: **1/500**
oct.2017
REGLEMENTARI EDILITARE

1712/2017
faza:
P.U.D.

P.U.D.
1712/2017

LOCUINTA SI IMPREJMUIRE

Aleea Gheorghe Hasnas Nr.19

LEGENDA



LIMITA PARCELA

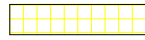

TEREN PROPRIETATE PRIVATA
conform c.v. nr.314 /13.04.2016



coordonator urbanism: arh. DAN O.BOTEZ

S.C. "CASA CHIRIAC" S.R.L. BOTOSANI R.C.J. J07 / 372 / 1992 - TEL. 0744.700798	beneficiar: CIOCAN BOGDAN - IONEL proiect: "CONSTRUIRE LOCUINTA SI IMPREJMUIRE TEREN" Aleea Gheorghe Hasnas Nr. 19 - Botosani	1712/2017 faza: P.U.D.
sef proiect: c.arh.marcel d.chiriac	scara: 1/500	CIRCULATIA TERENURILOR
proiectat: c.arh.marcel d.chiriac	oct.2017	
procesat: c.arh.marcel d.chiriac		A.05