



LEGENDA

-  **LIMITA ZONA STUDIATA**
-  **LIMITA DE PROPRIETATE = 591,00 mp.**
PROPRIETATE PRIVATA DANILA VASILICA
-  **SPATII VERZI = 591,00 mp.**
-  **ALEI TROTUARE**
-  **CAROSABIL PARCARI**

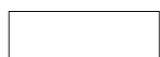
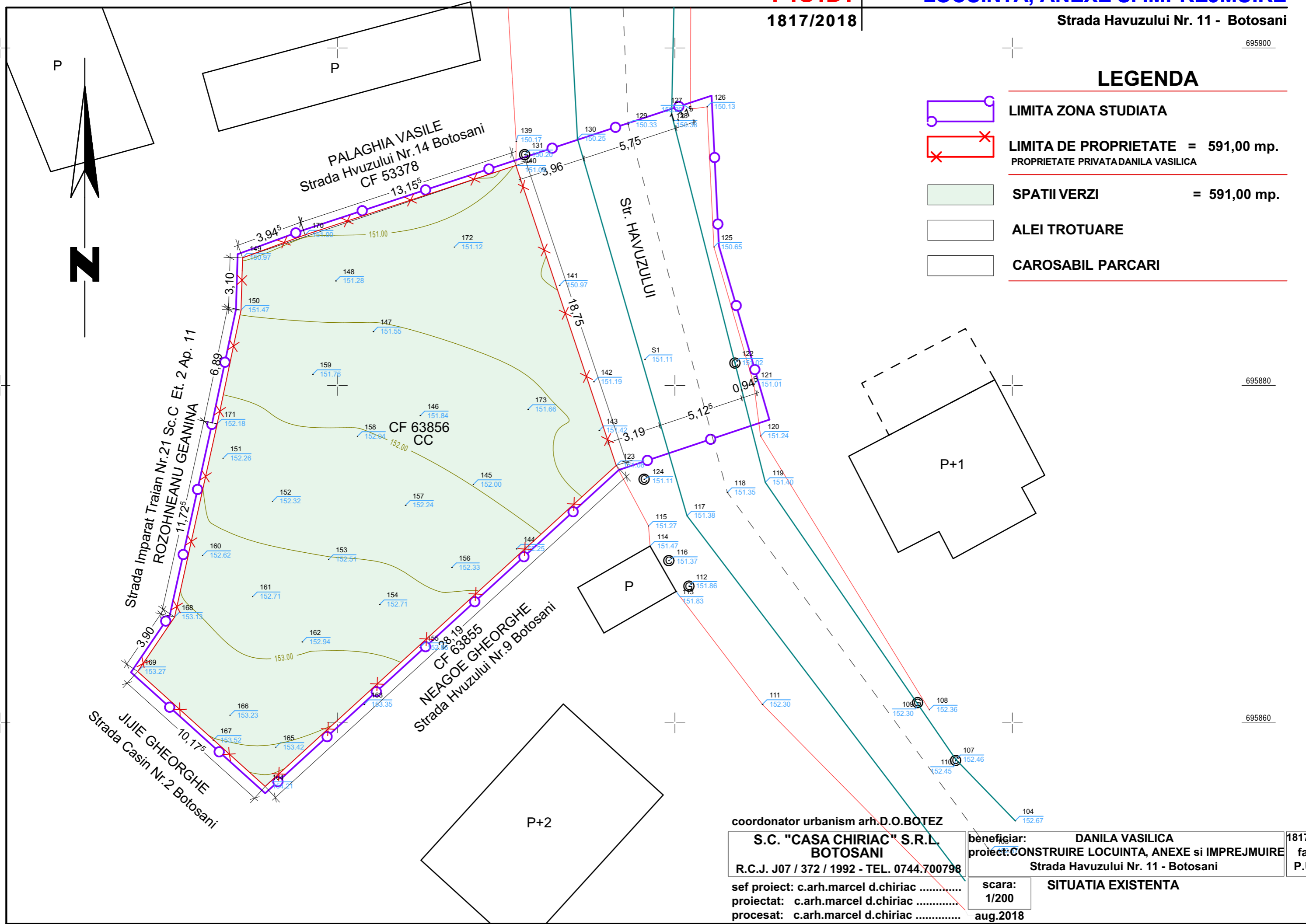

coordonator urbanism arh.D.O.BOTEZ
S.C. "CASA CHIRIAC" S.R.L.
BOTOSANI
 R.C.J. J07 / 372 / 1992 - TEL. 0744.700798
 sef proiect: c.arh.marcel d.chiriac
 proiectat: c.arh.marcel d.chiriac
 procesat: c.arh.marcel d.chiriac

beneficiar: **DANILA VASILICA**
 proiect: **CONSTRUIRE LOCUINTA, ANEXE si IMPREJMUIRE**
 Strada Havuzului Nr. 11 - Botosani

scara:
1/200
aug.2018

SITUATIA EXISTENTA

1817/2018
faza:
P.U.D.